



1000 SERIES SINGLE HEAD DIAPHRAGM PUMP

Versatile. Durable. Performance-optimized.

Product Snapshot



Max flow: up to **38 L/min** (1.3 cfm)



Max vacuum: **24 inHg** (200 mbar abs)



Max pressure: **18 psig** (1.2 bar)



Motor options: **Brushed or Brushless DC**



Operating voltage: **12 VDC** or **24 VDC**

Key Features



Flexible Integration:

Multiple port styles available



Serviceable design:

Replaceable diaphragms and heads



Proven performance:

Reliable under pressure and vacuum



Efficient design:

Rolled diaphragm boosts airflow



Customizable:

Motor, voltage, materials, and fittings

Technical Specifications

Parameter	Value
Max Flow	38 L/min (1.3 cfm)
Max Pressure	18 psig (1.2 bar)
Max Vacuum	24 inHg (200 mbar abs)
Operating Voltage	12 VDC or 24 VDC
Max Current Draw	3.0 A
Ambient / Media Temperature	41° F to 104° F (5° C to 40° C)
Weight	2.5 lb (1.1 kg)
Wetted Materials	PPS, Neoprene, Silicone



The **1000 Series** combines high flow performance with proven durability in a compact, serviceable design. These small, powerful diaphragm pumps operate efficiently with **low power consumption**, using up to 50% less energy than comparable models. **Fully customizable** and suited for both **pressure and vacuum applications**, they deliver reliable, adaptable performance across use cases from air sampling to medical aspirators and vacuum lifters.



1000 SERIES SINGLE HEAD DIAPHRAGM PUMP

Versatile. Durable. Performance-optimized.

Flow Curves

Vacuum, DV1032200

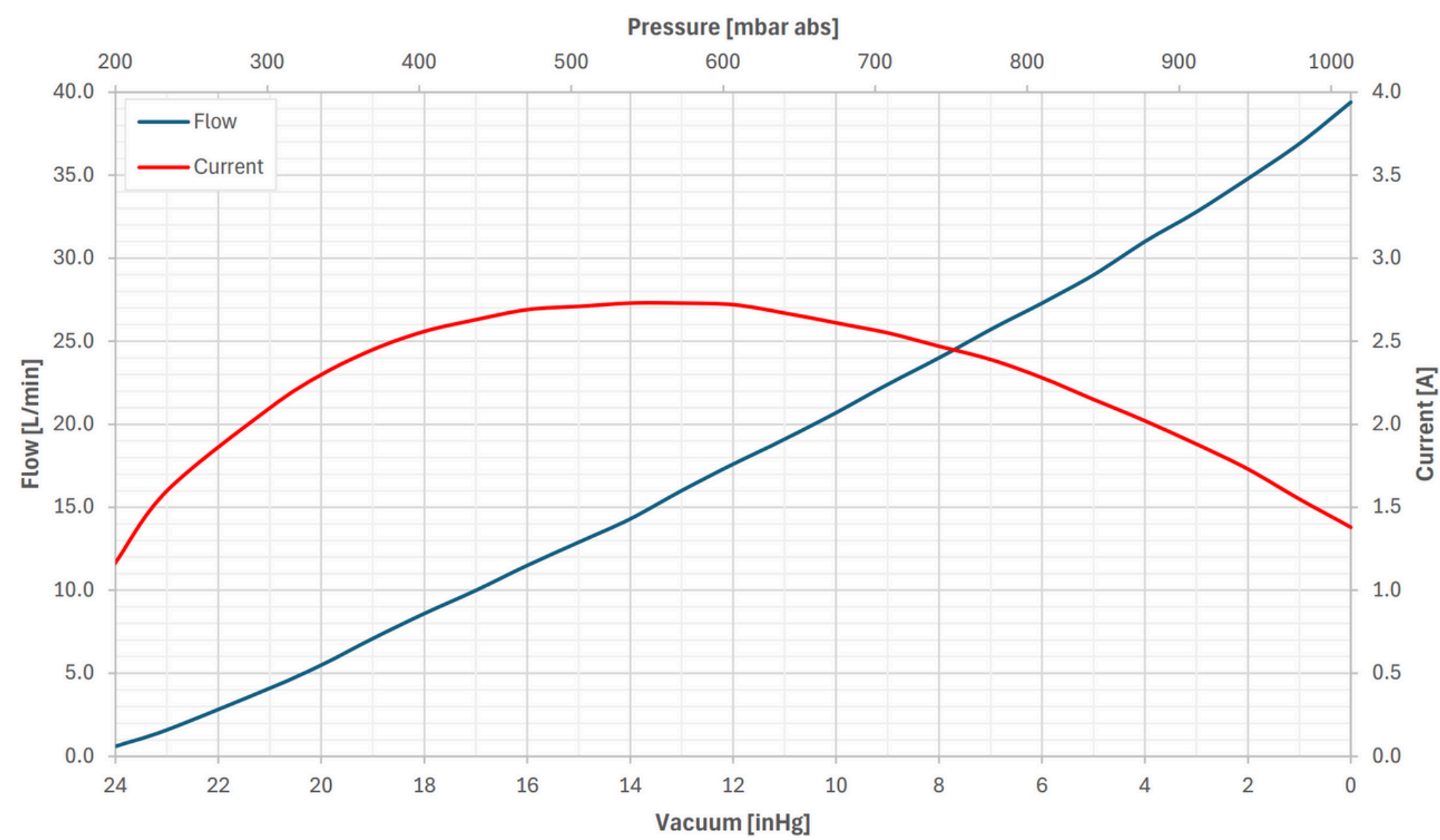

Pressure, DC1032200*

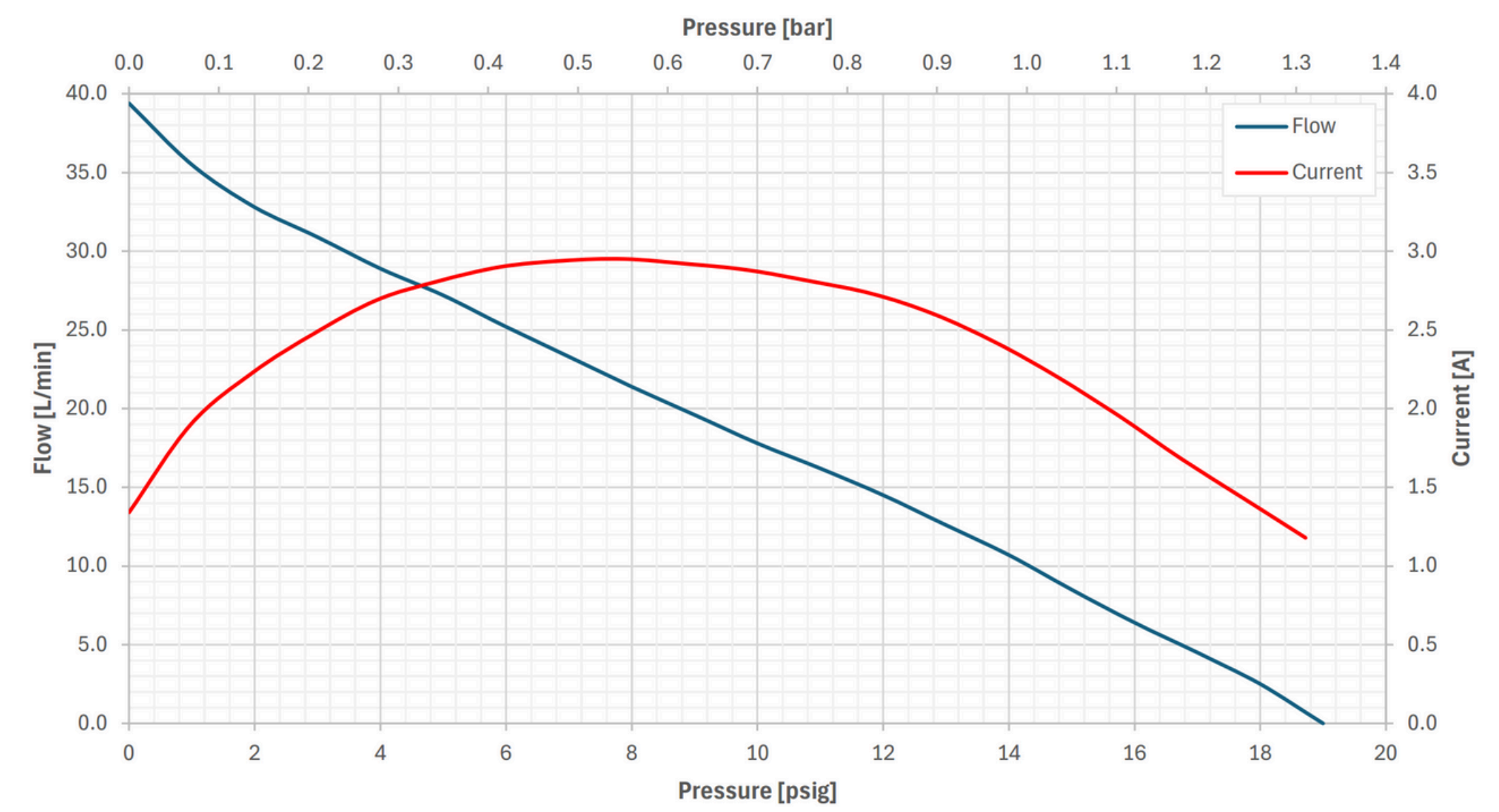

* Diaphragm is inverted 180° from vacuum (DV) configuration to compression (DC) configuration for maximum pressure use.

Dimensions

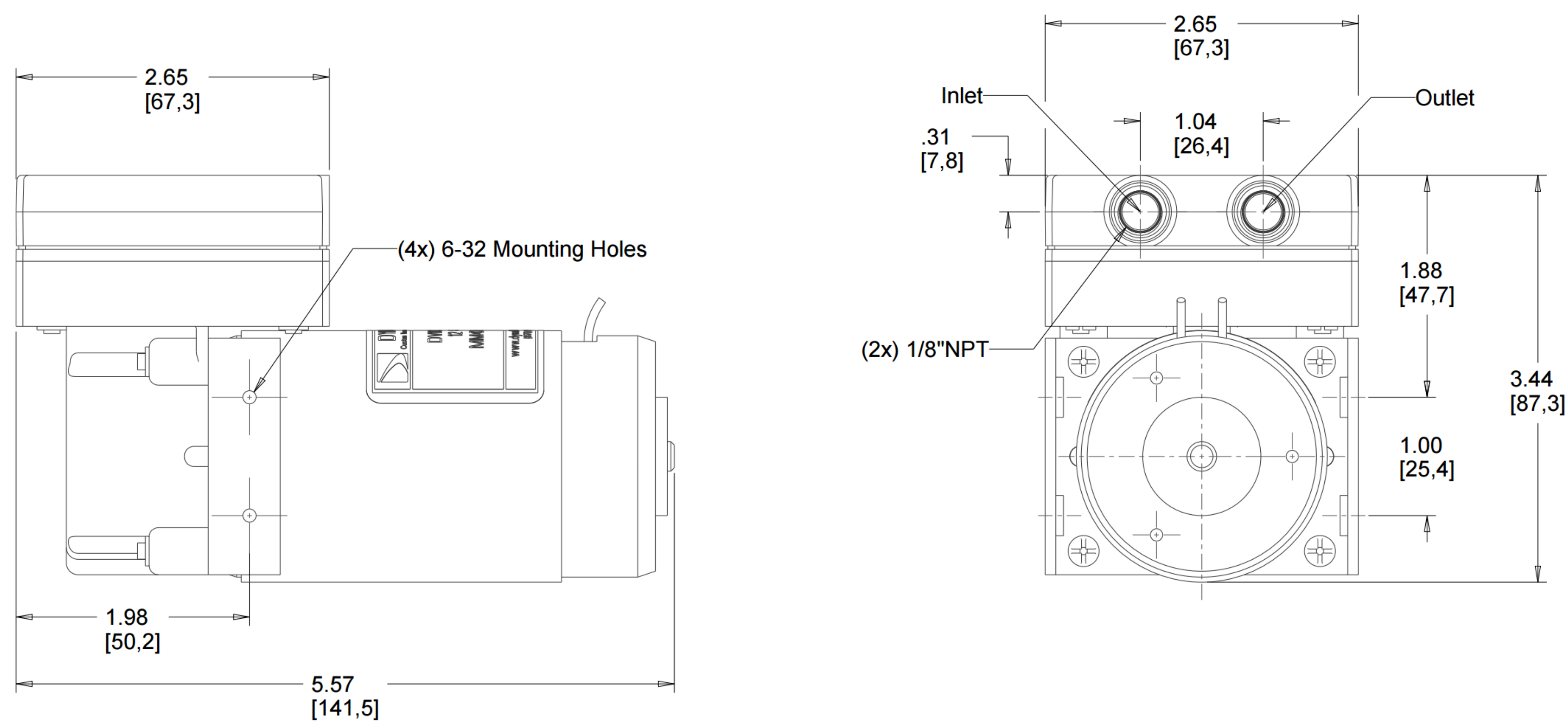

* Dimensions are in inches [mm]. DV1032200 or DC1032200 shown. 5.57 [141,5] dimension is motor selection dependent.

Available Customizations

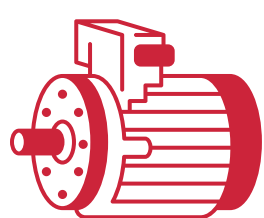

Motor types:
Brushed or Brushless DC

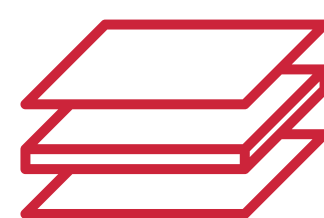

Valve and diaphragm materials

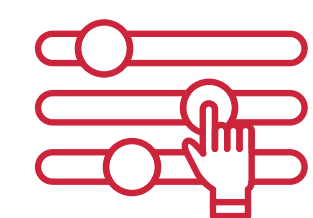

Optional eccentrics
for flow/pressure tuning



1000 SERIES DUAL HEAD DIAPHRAGM PUMP

Versatile. Durable. Performance-optimized.

Product Snapshot



Max flow: up to **75 L/min** (2.6 cfm)



Max vacuum: **28 inHg** (70 mbar abs)



Max pressure: **40 psig** (2.8 bar)



Motor options: **Brushed or Brushless DC**



Operating voltage: **12 VDC** or **24 VDC**

Key Features



Flexible Integration:

Multiple port styles available



Serviceable design:

Replaceable diaphragms and heads



Proven performance:

Reliable under pressure and vacuum



Efficient design:

Rolled diaphragm boosts airflow

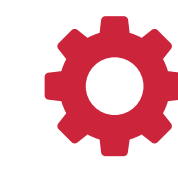

Customizable:

Motor, voltage, materials, and fittings

Technical Specifications

Parameter	Value
Max Flow, Series or Parallel	38 or 75 L/min (1.3 or 2.6 cfm)
Max Pressure, Series or Parallel	40 or 18 psig (2.8 or 1.2 bar)
Max Vacuum, Series or Parallel	28 or 24 inHg (70 or 200 mbar abs)
Operating Voltage	12 VDC or 24 VDC
Max Current Draw	4.5 to 6.0 A
Ambient / Media Temperature	41° F to 104° F (5° C to 40° C)
Weight	2.9 lb (1.3 kg)
Wetted Materials	PPS, Neoprene, Silicone



The **1000 Series** combines high flow performance with proven durability in a compact, serviceable design. These small, powerful diaphragm pumps operate efficiently with **low power consumption**, using up to 50% less energy than comparable models. **Fully customizable** and suited for both **pressure and vacuum applications**, they deliver reliable, adaptable performance across use cases from air sampling to medical aspirators and vacuum lifters.



1000 SERIES DUAL HEAD DIAPHRAGM PUMP

Versatile. Durable. Performance-optimized.

Flow Curves

Vacuum, DV1034200 (Series)

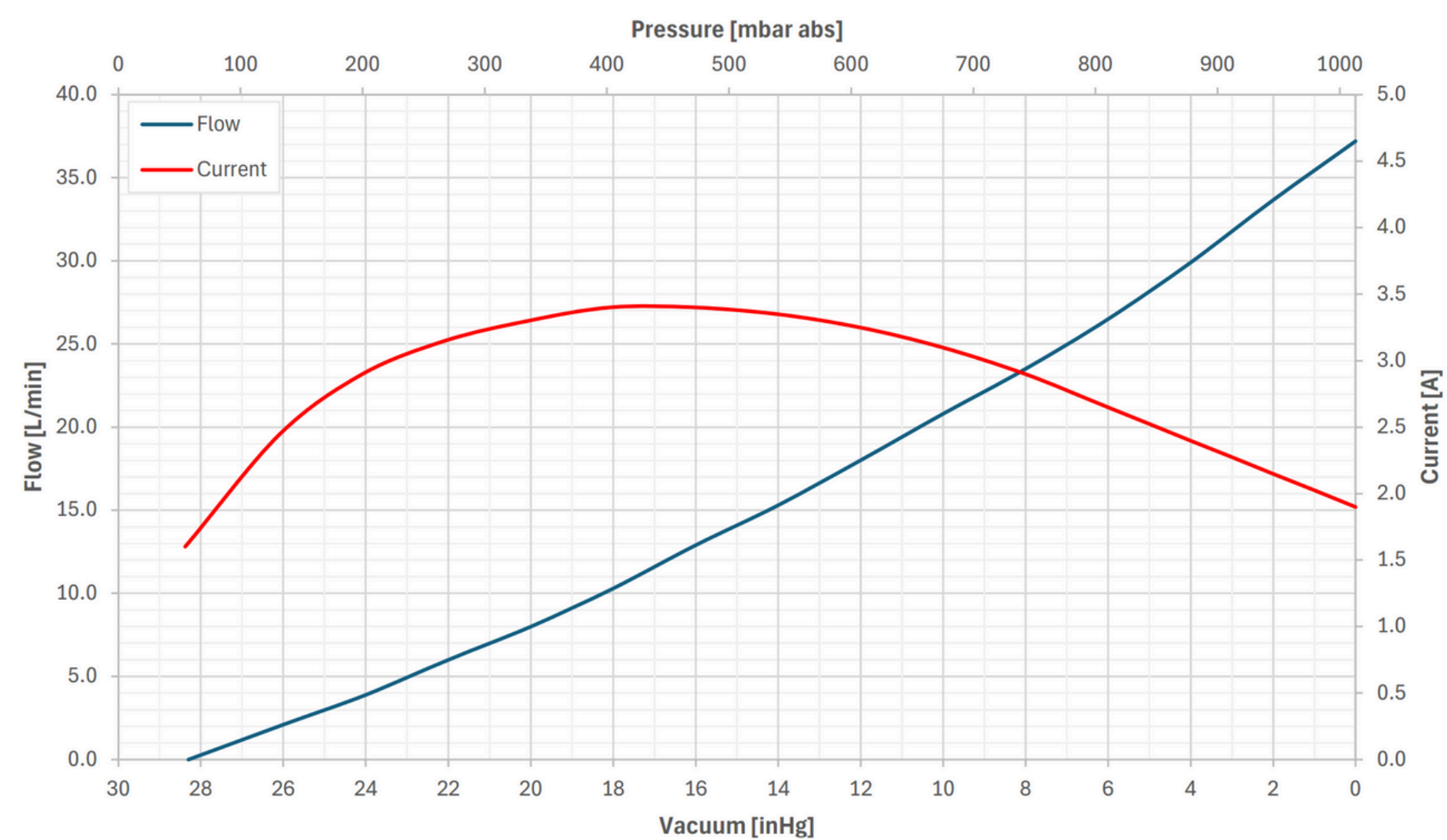

Pressure, DC1034200 (Series)*

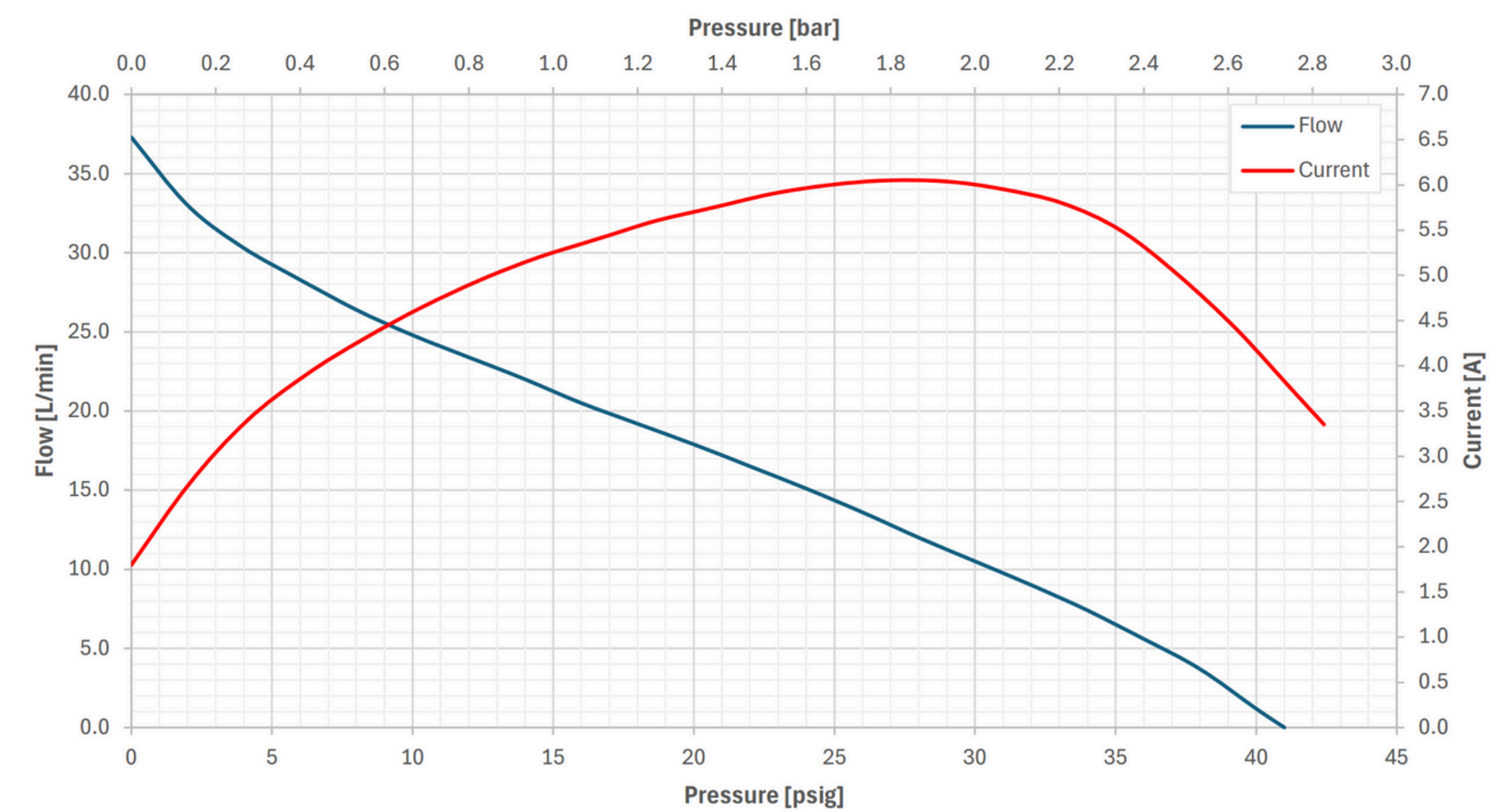

Vacuum, DV1034200 (Parallel)

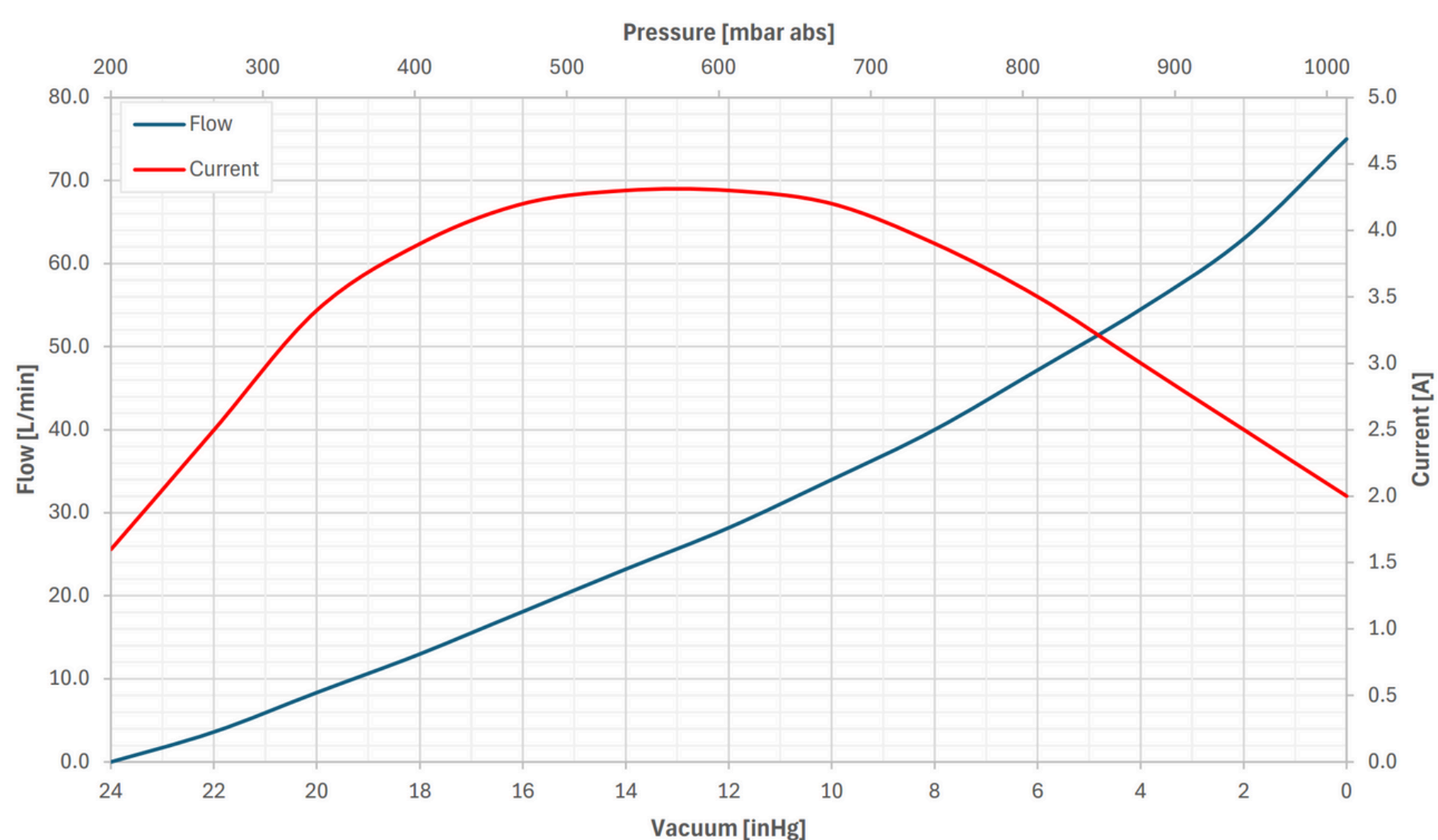

Pressure, DC1034200 (Parallel)*

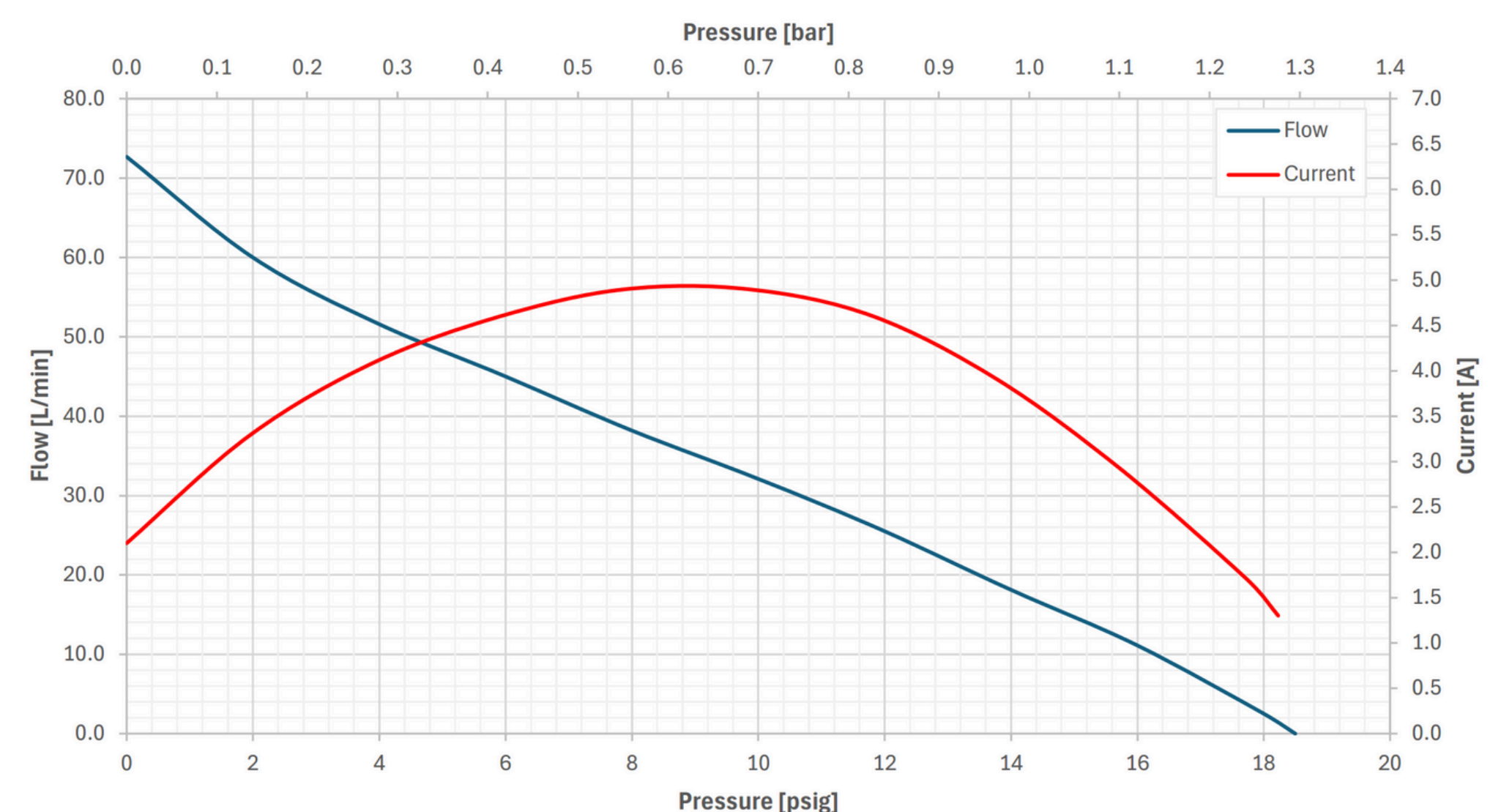

* Diaphragm(s) are inverted 180° from vacuum (DV) configuration to compression (DC) configuration for maximum pressure use.

Dimensions

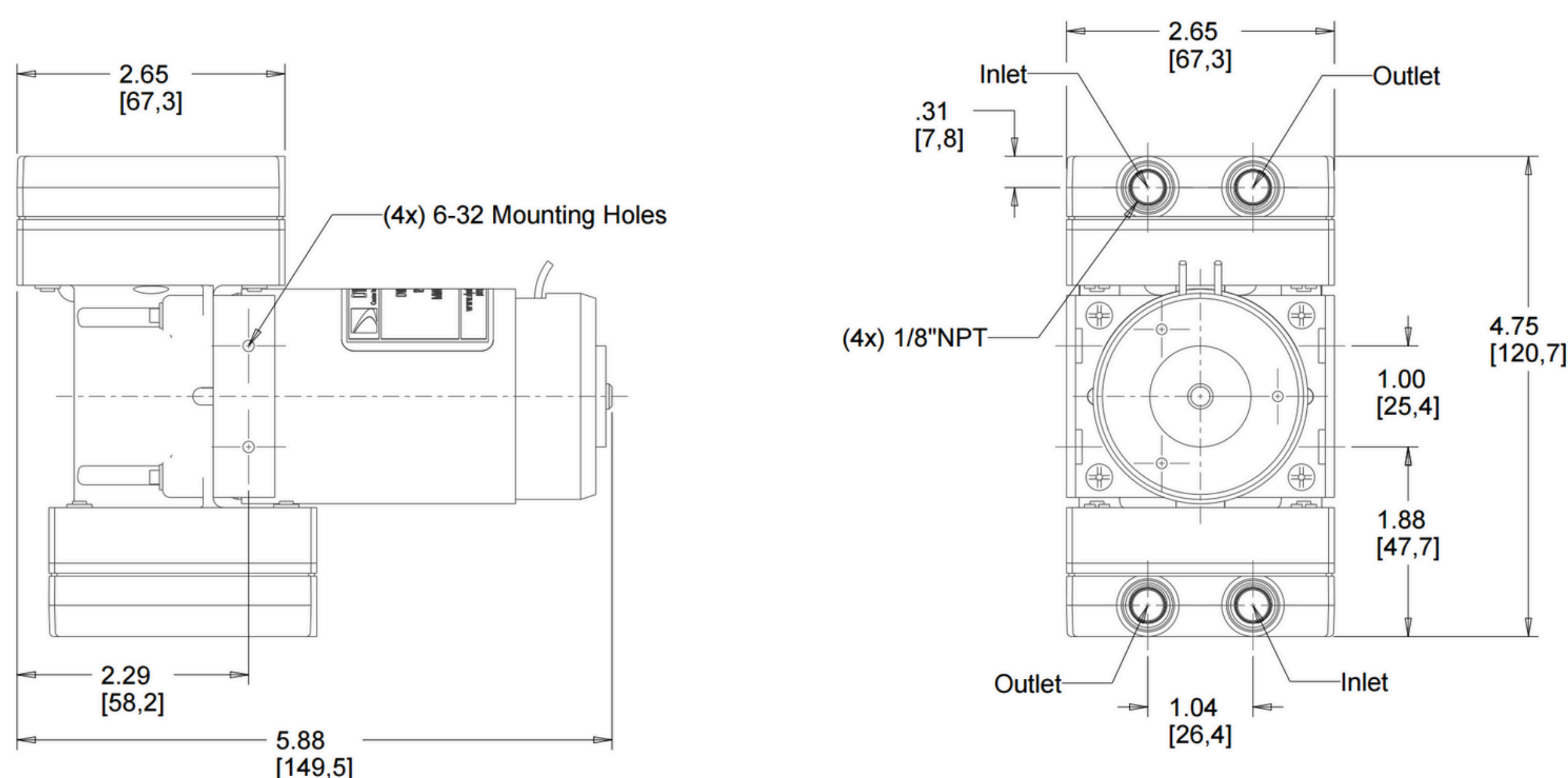

* Dimensions are in inches [mm]. DV1034200 or DC1034200 shown. 5.88 [149,5] dimension is motor selection dependent.

Available Customizations

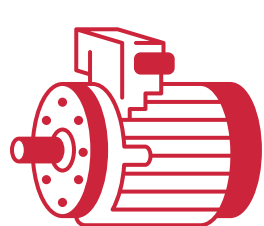

Motor types:
Brushed or Brushless DC

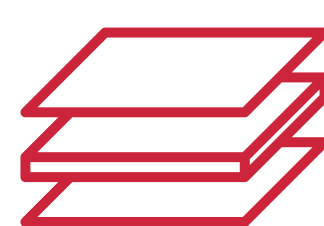

Valve and diaphragm materials

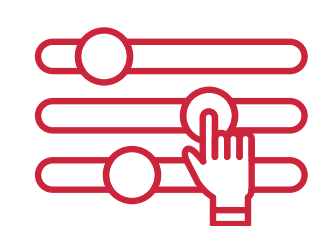

Optional eccentrics
for flow/pressure tuning



2000 SERIES MICRO DIAPHRAGM PUMP

Lightweight. High-Performance. Energy-Efficient.

Product Snapshot



Max flow: up to **1.15 L/min (0.04 cfm)**



Max vacuum: **24 inHg** (200 mbar abs)



Max pressure: **30 psig** (2 bar)



Motor options: **Brushed DC**



Operating voltage: **3.7 to 6.0 VDC**

Key Features



Ultra-lightweight:

0.8 oz (25 g) for compact integrations



Strong & steady:

High-torque motor maintains suction



Energy-efficient:

Draws under 1 W at full vacuum



Compact footprint:

Fits in micro-engineering designs



Customizable:

Flow, motor, ports, materials, etc.

Technical Specifications

Parameter	Value
Max Flow	1.15 L/min (0.04 cfm)
Max Pressure	30 psig (2 bar)
Max Vacuum	24 inHg (200 mbar abs)
Operating Voltage	3.7 to 6.0 VDC
Max Current Draw	0.5 A
Ambient / Media Temperature	41° F to 104° F (5° C to 40° C)
Weight	0.8 oz (25 g)
Wetted Materials	PC, Neoprene, Silicone



The **2000 Series** delivers high vacuum performance in an **ultra-compact, lightweight design**. These small yet powerful diaphragm pumps operate **efficiently with minimal power consumption**, making them ideal for **portable and battery-powered devices**. Fully customizable and suitable for both **vacuum and pressure applications**, they provide reliable, adaptable performance **across industries** where space, weight, and efficiency are critical.



2000 SERIES MICRO DIAPHRAGM PUMP

Lightweight. High-Performance. Energy-Efficient.

Flow Curves

Vacuum, DD2102200

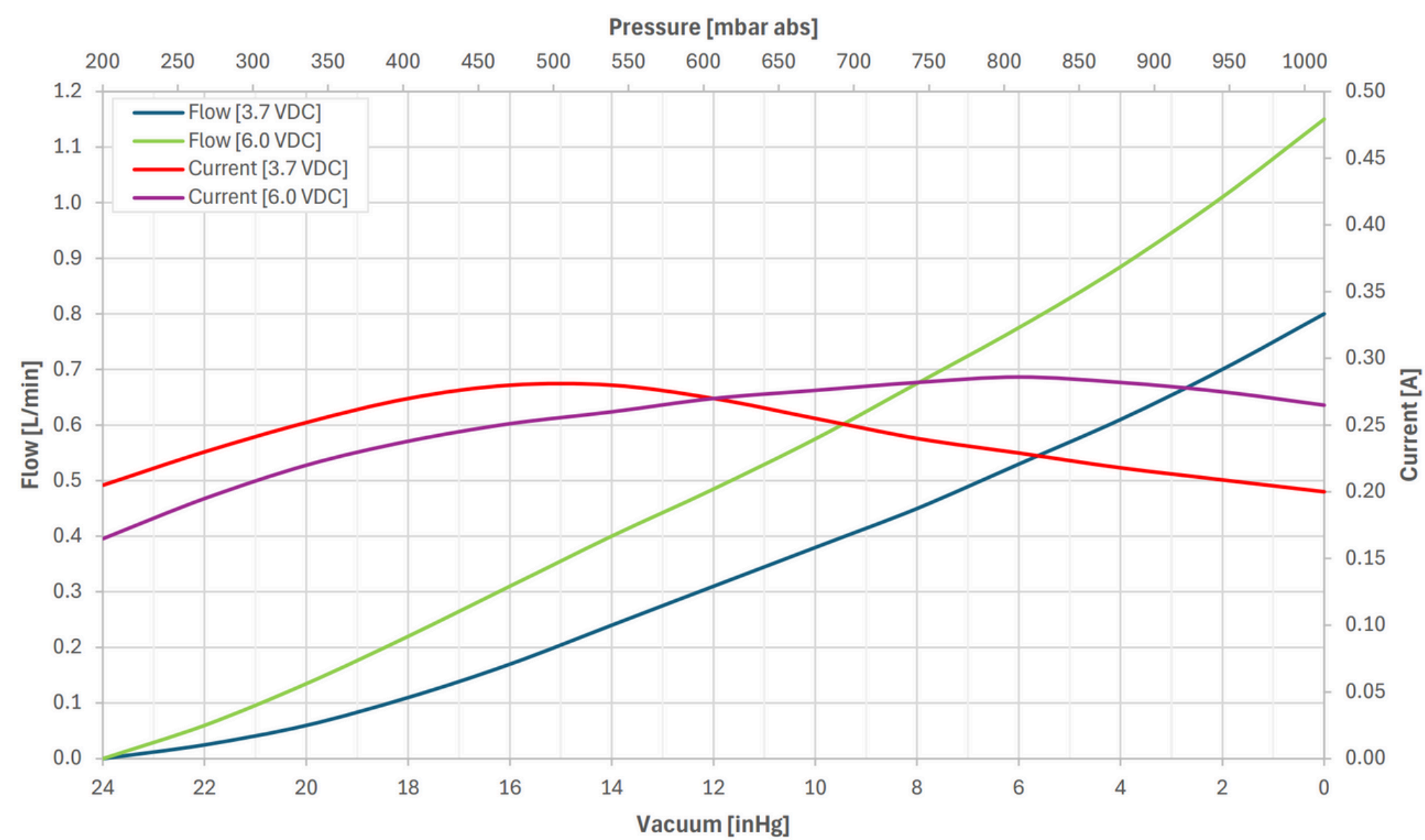

Pressure, DD2102200

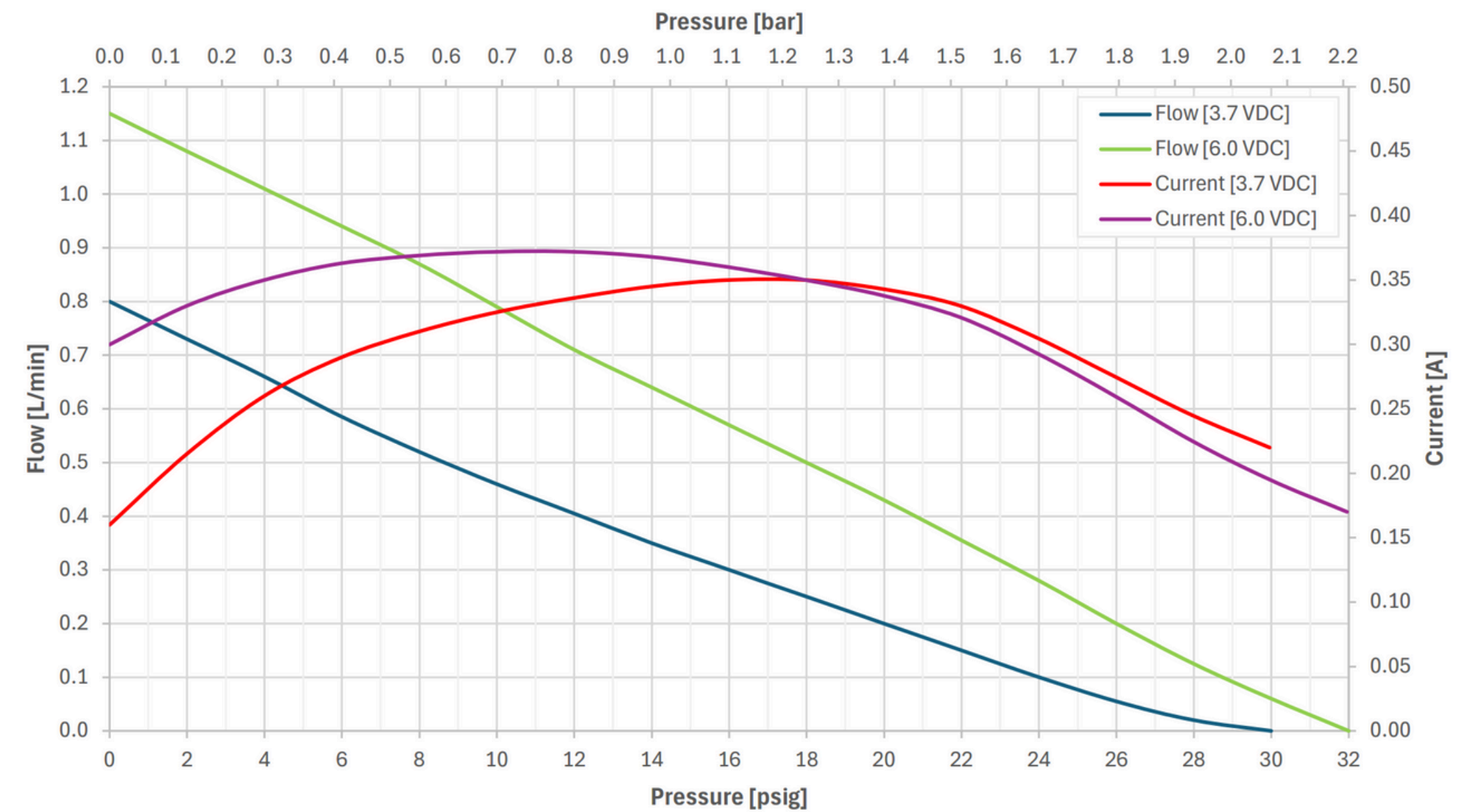

Dimensions

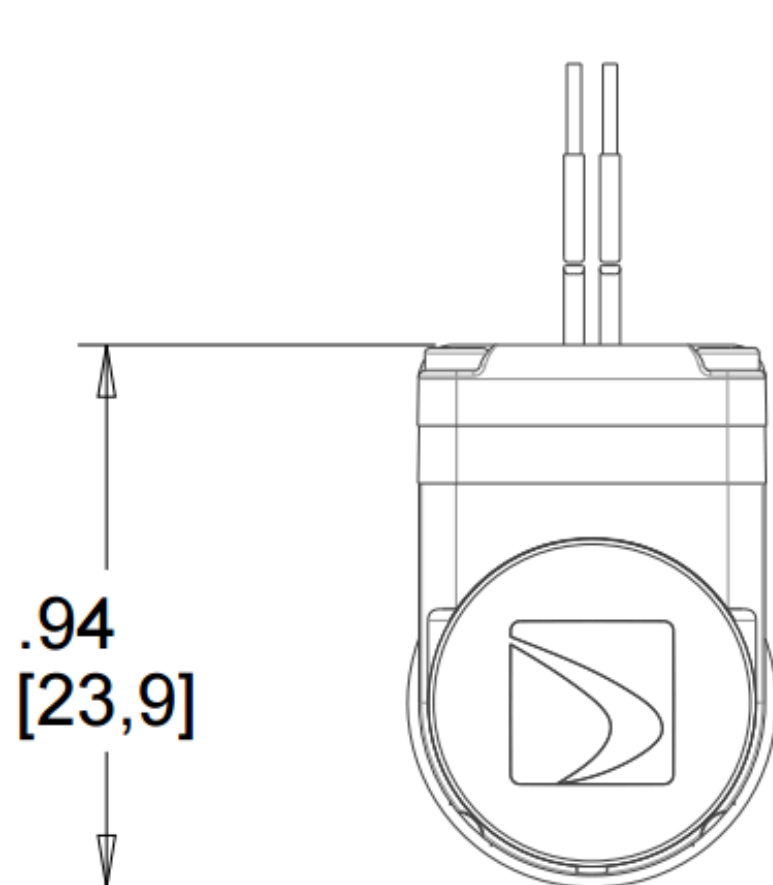
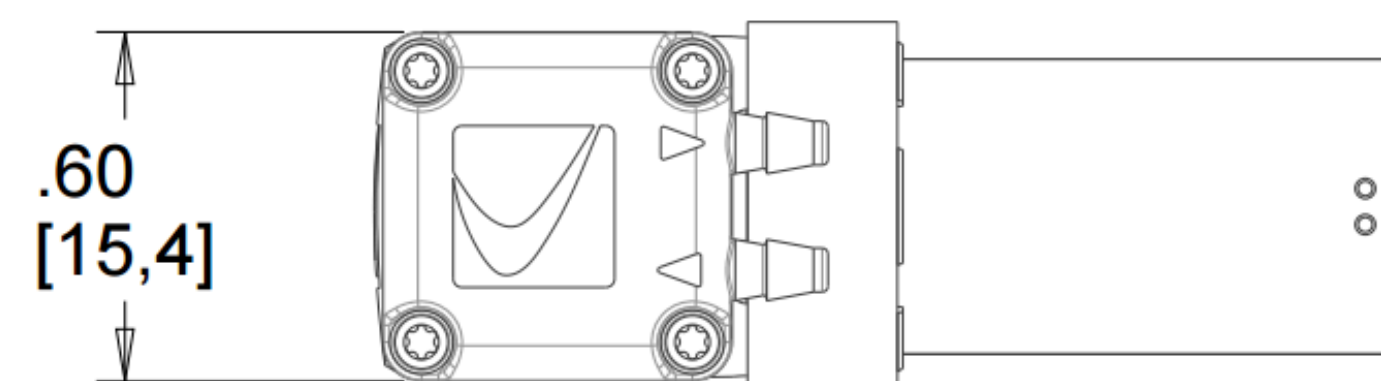

(2x) 1/16" Hose Barb

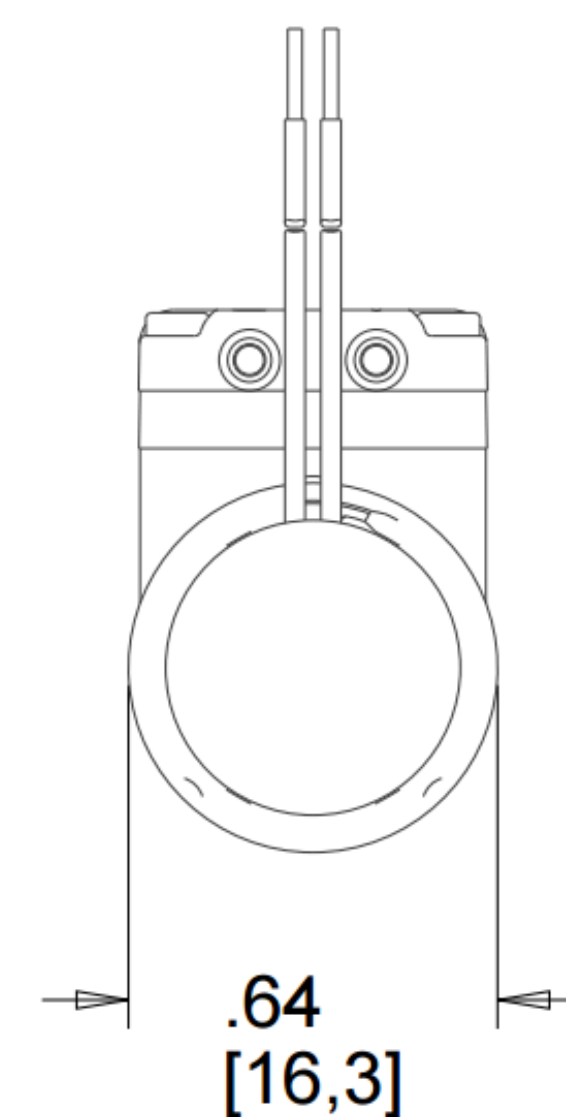
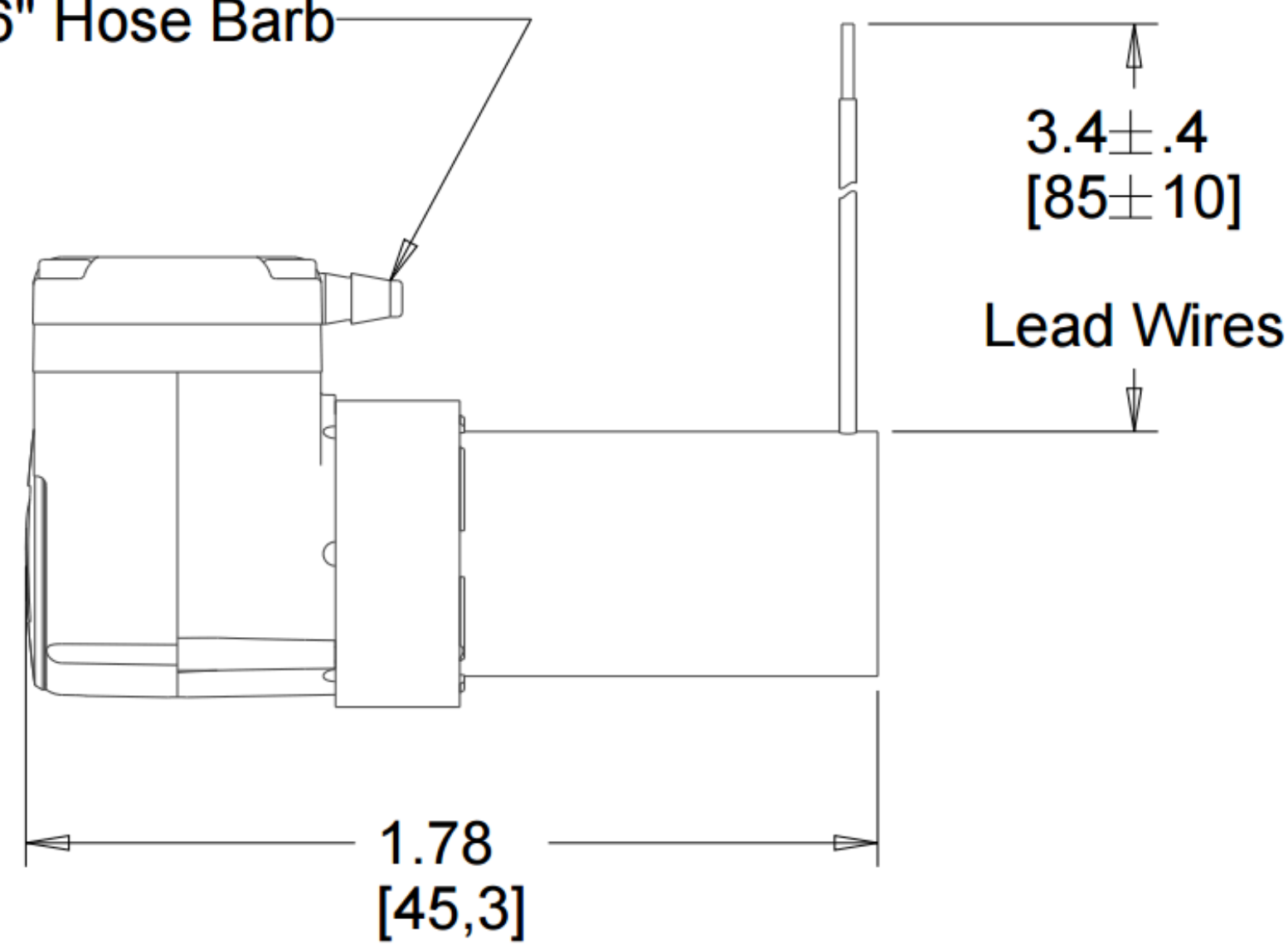

* Dimensions are in inches [mm]. DD2102200 shown. 1.78 [45,3] dimension is motor selection dependent.

Available Customizations

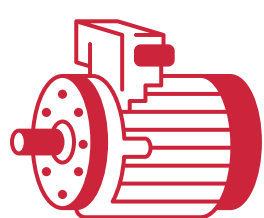

Motor types: Brushed DC

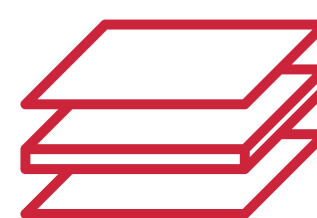

Valve and diaphragm materials

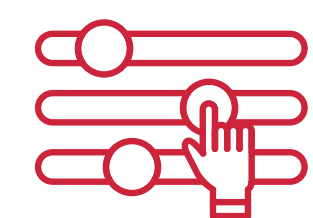

Optional eccentrics
for flow/pressure tuning



3000 SERIES SMOOTH FLOW DIAPHRAGM PUMP

Smooth. Consistent. Reliable.

Product Snapshot



Max flow: up to **140 L/min** (4.9 cfm)



Max pressure: **2 psig** (140 mbar rel)



Power & Flow: **2.7 lpm/W**



Motor option: **Brushless DC**



Operating voltage: **12 VDC**

Key Features

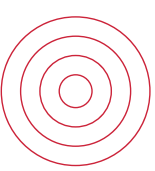

Patented Smooth-Flow Technology:
Ultra-smooth, pulse-free airflow



High efficiency:
Long-life brushless DC motor



Durable radial design:
Reduced strain, longer life



Wide operating range:
from -40° F to 120 °F (-40° C to 50 °C)



Customizable integration:
Flow, ports, materials, etc.

Technical Specifications

Parameter	Value
Max Flow	140 L/min (4.9 cfm)
Max Pressure	2 psig (140 mbar rel)
Operating Voltage	12 VDC
Max Current Draw	5.5 A
Ambient / Media Temperature	-40° F to 120 °F (-40° C to 50 °C)
Weight	1.5 lb (0.7 kg)
Wetted Materials	PC, EPDM, Silicone



The **3000 Series** delivers **smooth, pulse-free airflow** in a **durable and efficient design**. Powered by a **long-life brushless DC motor**, these diaphragm pumps combine **high flow output with low-pressure stability**, ensuring consistent performance across demanding applications. With a patented **12-head radial configuration**, they reduce vibration, extend lifespan, and enable reliable use in environments from **-40° F to 120° F**. Fully **customizable** and ideal for products that require **steady, high-volume airflow** at low pressure, the 3000 Series offers **confidence, efficiency, and adaptability** across industries.

Flow Curve

Pressure, DP0003001

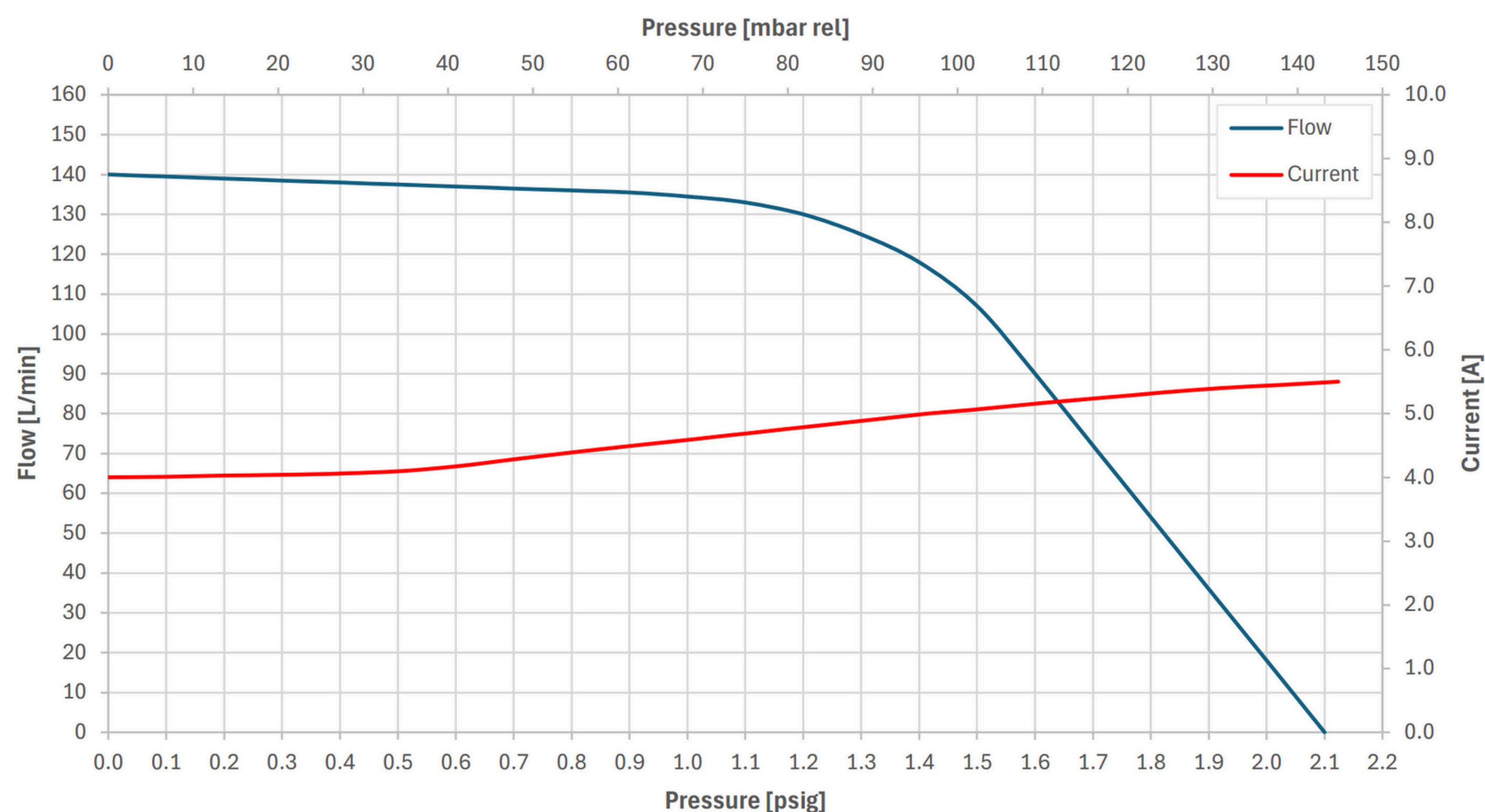

Dimensions

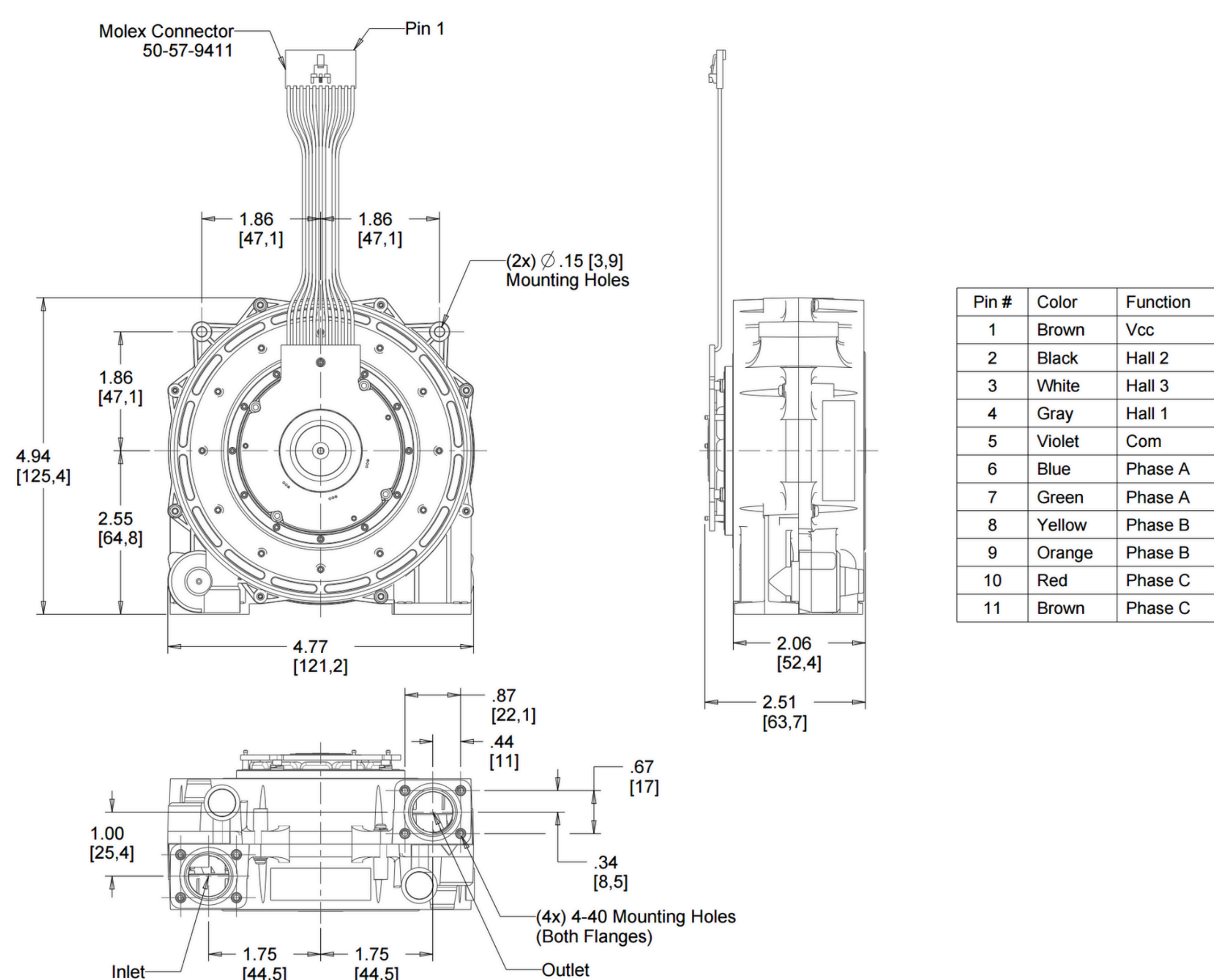

* Dimensions are in inches [mm]. DP0003001 shown.

Available Customizations

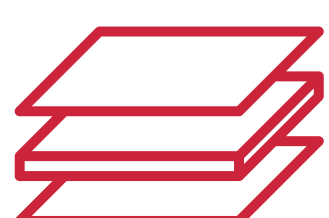

Valve and diaphragm materials

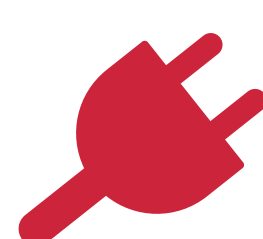

Wiring Harness: Tailored motor wiring and connectors

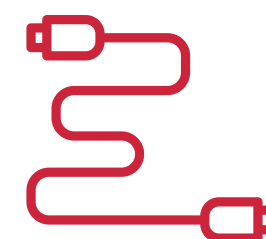

Suction & Discharge Adapters: Machined or plastic options available

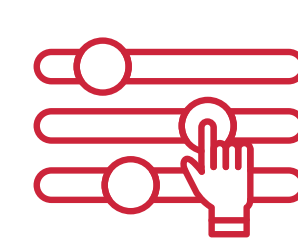

Port Interface: Flanged connection for easy device integration



4000 SERIES MICRO DIAPHRAGM PUMP

Ultra-compact. High-performance. Unmatched efficiency.

Product Snapshot



Max flow: up to **360 mL/min**



Battery runtime: up to **31 hrs**



Volume: **Smallest** footprint in class



Dual function: **Vacuum & Compression**



Operating voltage: **3.7 to 4.2 VDC**

Key Features



Extremely compact:
Designed for miniaturized systems



Outstanding output:
Maintains up to 360 mL/min



Low current draw:
Efficient for battery-powered devices



Dual-use:
Works in compression and vacuum modes



Customizable:
Voltage and mounting options.

Technical Specifications

Parameter	Value
Operating RPM	4000 to 7000 RPM
Flow Rate Range	250 to 360 mL/min
Unrestricted Max Flow	520 to 550 mL/min @ ~45 mA
Max Pressure	20 psig (1.4 bar)
Max Vacuum	18 inHg (400 mbar abs)
Operating Voltage	3.7 to 4.2 VDC
Max Current Draw	112 mA
Ambient / Media Temperature	41° F to 104° F (5° C to 40° C)
Weight	0.5 oz (15 g)
Wetted Materials	PC, Neoprene, Silicone

Battery Runtime

Battery (mAh)	Runtime
2000	17:51
2500	22:19
3000	26:47
3500	31:25

The **4000 Series** delivers exceptional performance in the **smallest package** Dynaflo has ever engineered – making it the ideal solution for compact, battery-powered systems **where space, efficiency, and reliability are critical.**



4000 SERIES MICRO DIAPHRAGM PUMP

Ultra-compact. High-performance. Unmatched efficiency.

Flow Curves

Vacuum, DD4112200

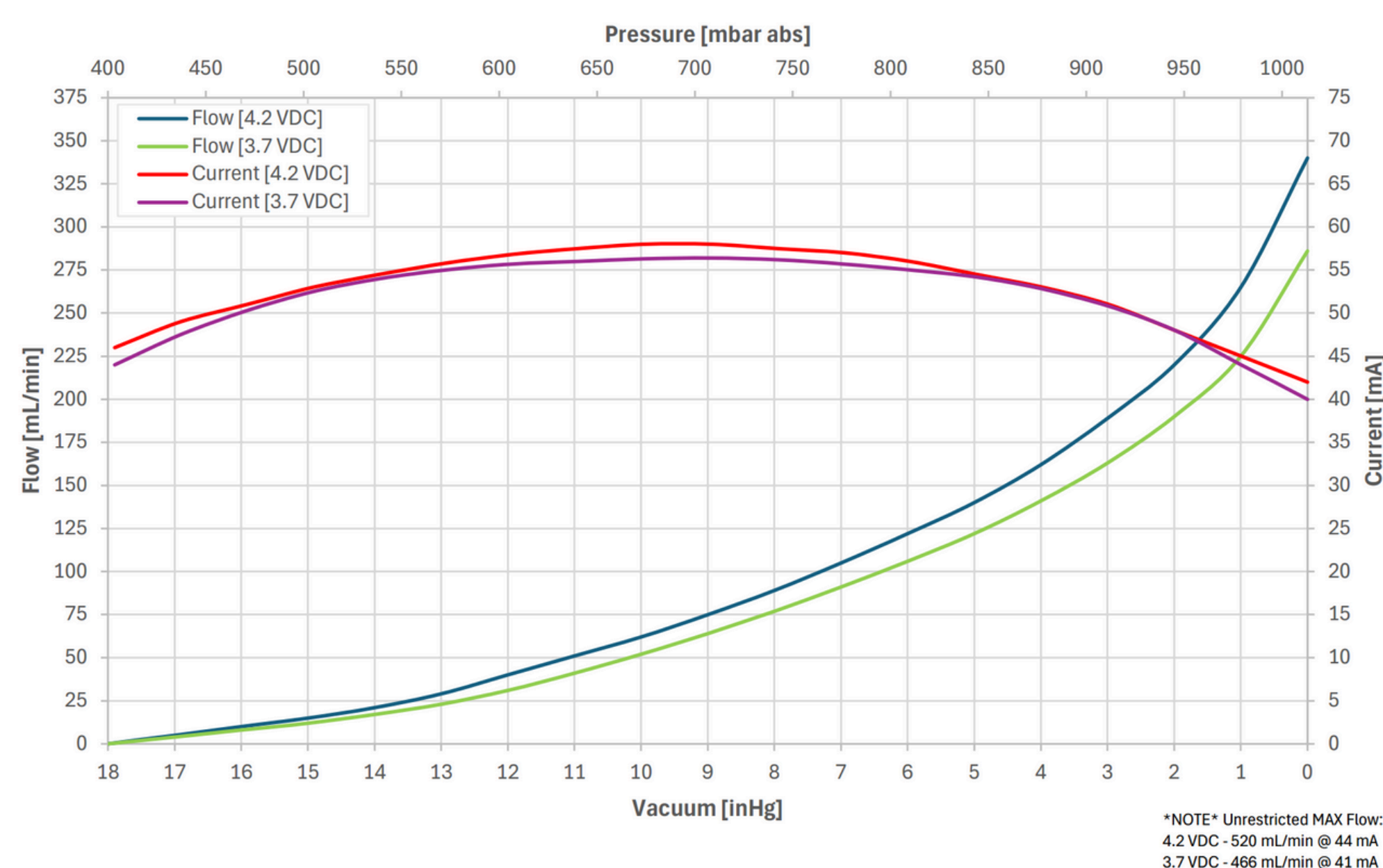

Compression, DD4112200

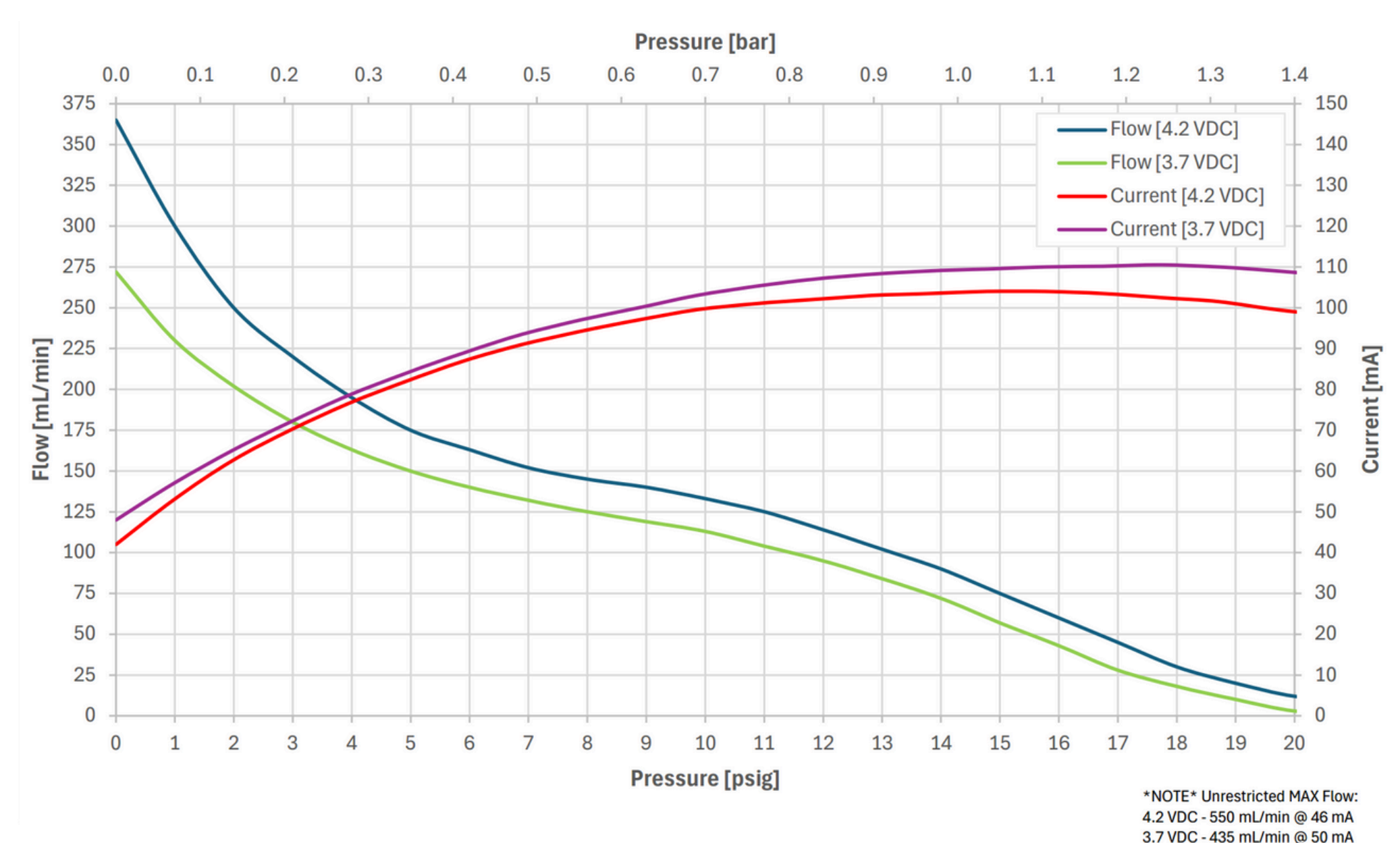

Mode	Voltage	Max Flow (mL/min)	Max Current (mA)
Compression	4.2 VDC	550	46
Compression	3.7 VDC	435	50
Vacuum	4.2 VDC	520	44
Vacuum	3.7 VDC	466	41

Dimensions

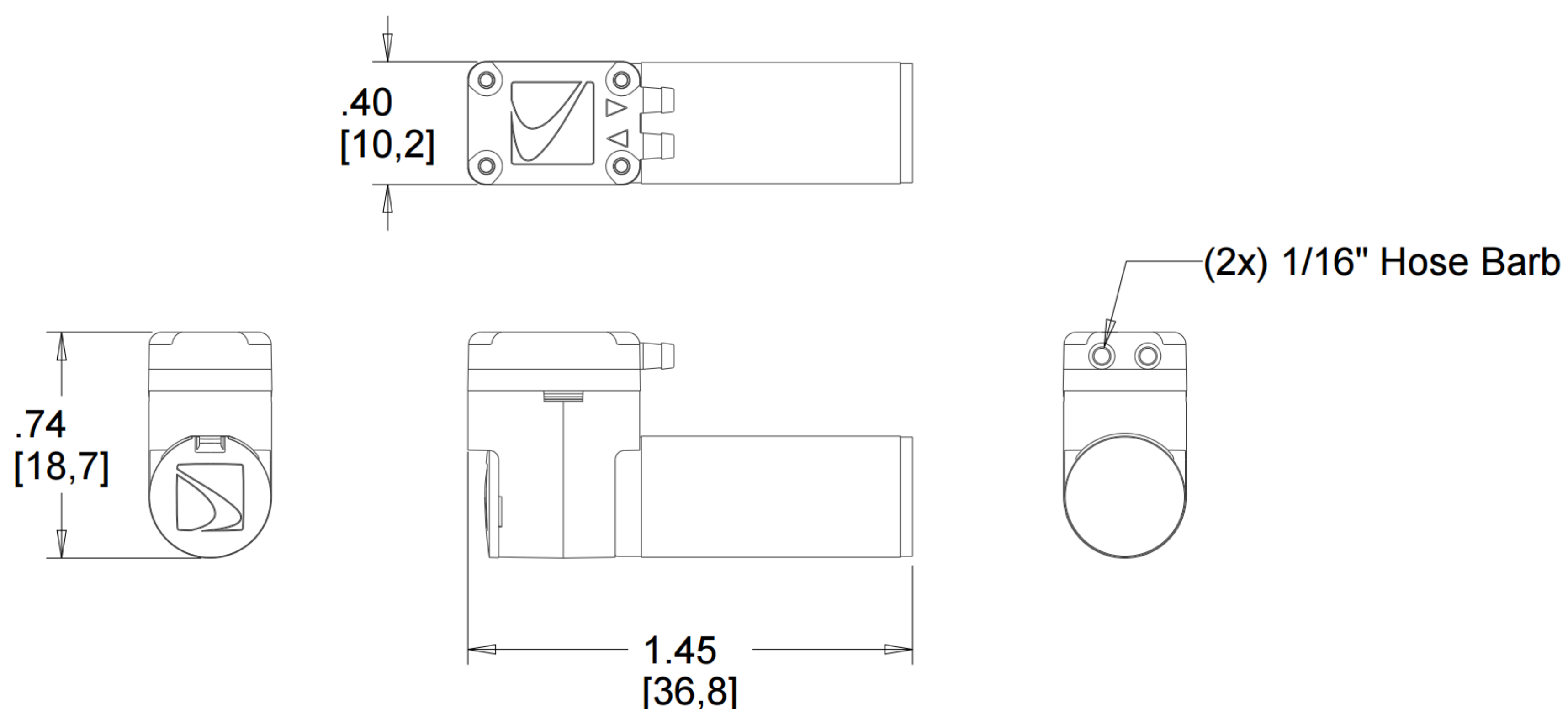

*Dimensions are in inches [mm]. DD4112200 shown. 1.45 [36,8] dimension is motor selection dependent.



6000 SERIES SINGLE HEAD MINI DIAPHRAGM PUMP

Compact. Precise. Reliable performance in miniature design.

Product Snapshot



Max flow: up to **5.0 L/min** (0.18 cfm)



Max vacuum: **26 inHg** (133 mbar abs)



Max pressure: **50 psig** (3.4 bar)



Motor options: **Brushed or Brushless DC**



Operating voltage: **12 VDC** or custom

Key Features



Compact & lightweight:

3.0 oz (85 g), portable, space-saving



Precise control:

Short pressure/vacuum bursts, accurate flow



Reliable under load:

Safe restarts, consistent performance



Durable design:

Tested for thousands of on/off cycles



Customizable:

Motors, voltages, materials

Technical Specifications

Parameter	Value
Max Flow	5.0 L/min (0.18 cfm)
Max Pressure	50 psig (3.4 bar)
Max Vacuum	26 inHg (133 mbar abs)
Operating Voltage	12 VDC or custom
Max Current Draw	0.9 A
Ambient / Media Temperature	41° F to 104° F (5° C to 40° C)
Weight	3.0 oz (85 g)
Wetted Materials	Glass-Filled LCP, EPDM, Silicone



The **6000 Series** combines **precise flow control** with a **compact, ultra-lightweight design**. Delivering short bursts of pressure and vacuum, these miniature diaphragm pumps ensure **reliable performance even under load**. Tested for thousands of rapid cycles, they offer **long-term durability while maintaining low power consumption**. Fully customizable in motor type, voltages, and materials, the 6000 Series provides **versatile solutions for applications where accuracy, reliability, and portability are essential**.

6000 SERIES SINGLE HEAD MINI DIAPHRAGM PUMP

Compact. Precise. Reliable performance in miniature design.

Flow Curves

Vacuum, DD6112201

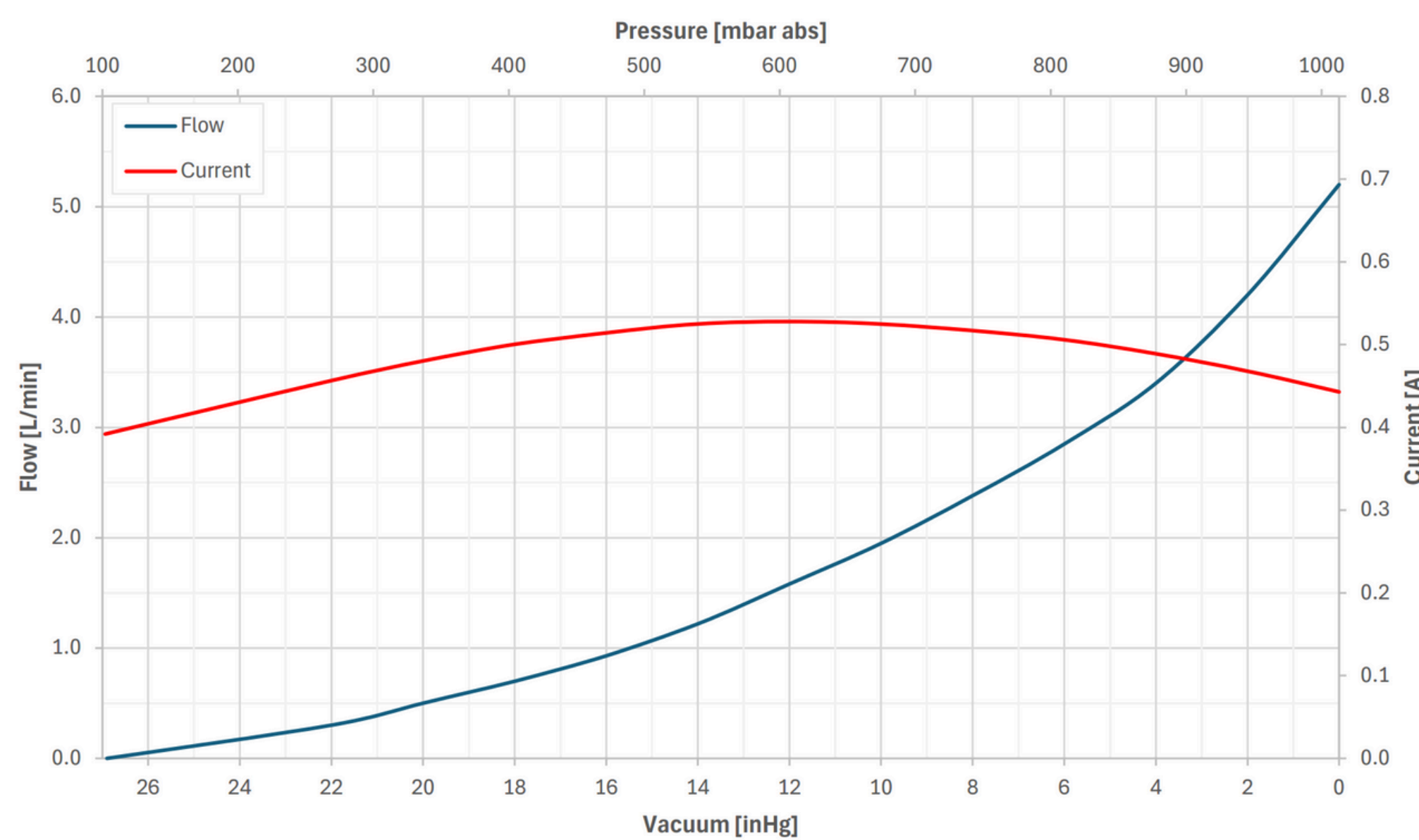

Pressure, DD6112201

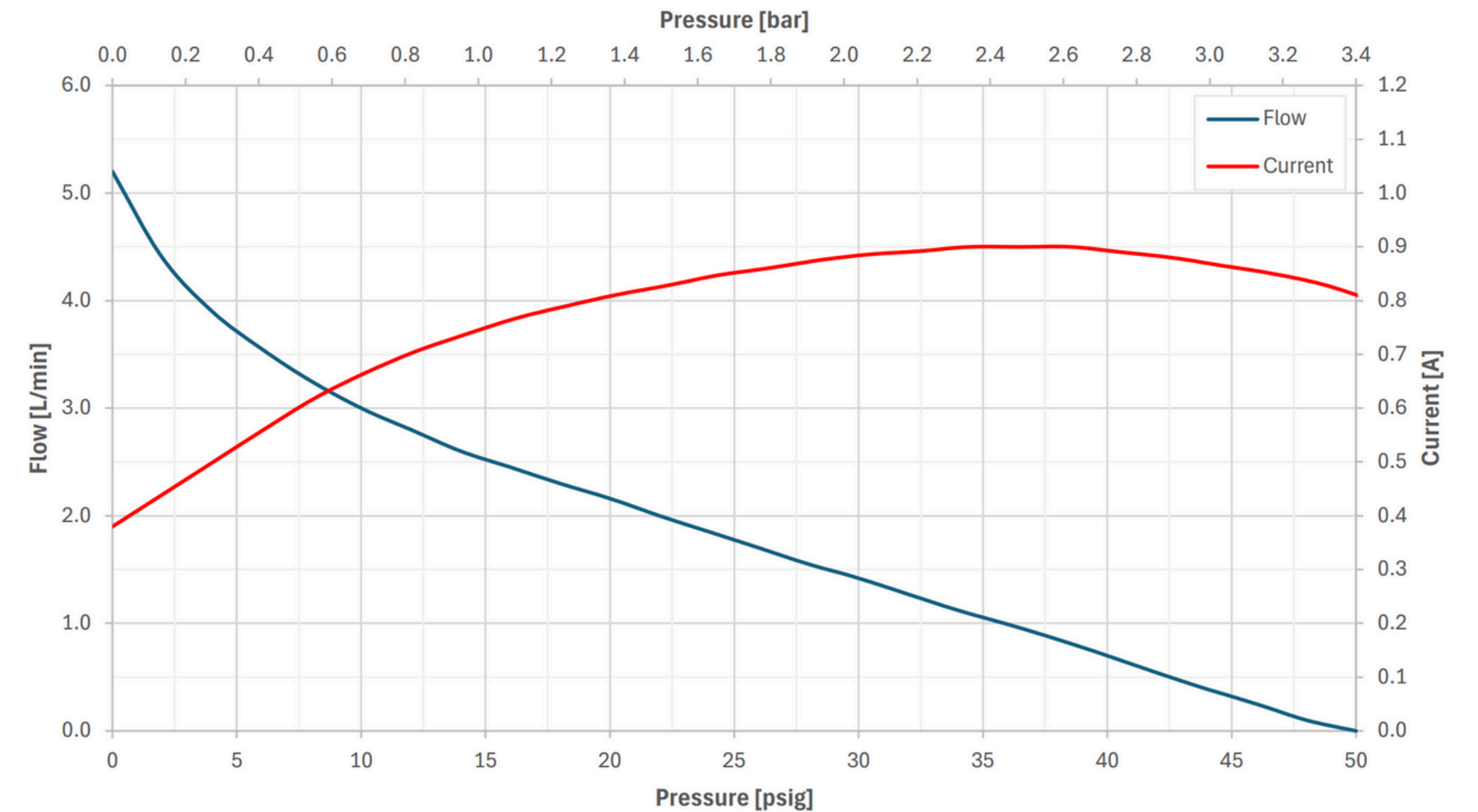

Dimensions

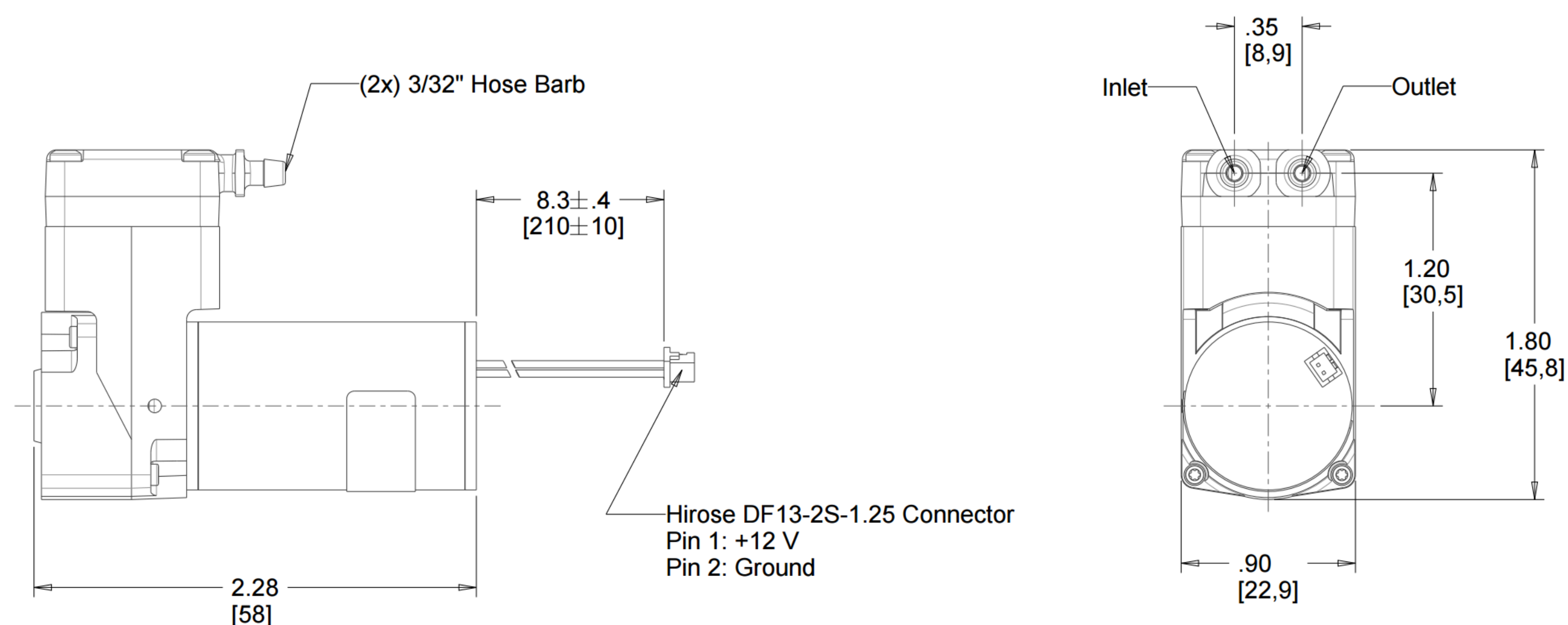

* Dimensions are in inches [mm]. DD6112201 shown. 2.28 [58] dimension is motor selection dependent.

Available Customizations

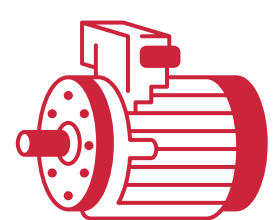

Motor types:
Brushed or Brushless DC

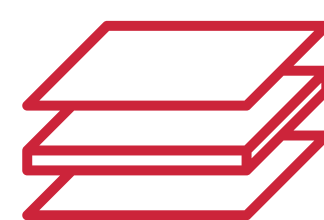

Valve and diaphragm materials

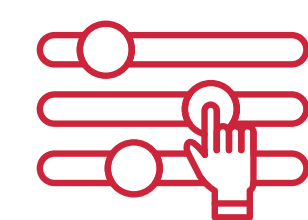

Optional eccentrics
for flow/pressure tuning



6000 SERIES

DUAL HEAD MINI DIAPHRAGM PUMP

Compact. Precise. Reliable performance in miniature design.

Product Snapshot



Max flow: up to **9.5 L/min** (0.34 cfm)



Max vacuum: **27 inHg** (100 mbar abs)



Max pressure: **14 psig** (~1.0 bar)



Motor options: **Brushed or Brushless DC**



Operating voltage: **12 VDC** or custom

Key Features



Compact & lightweight:

3.2 oz (90 g), portable, space-saving



Precise control:

Short pressure/vacuum bursts, accurate flow



Reliable under load:

Safe restarts, consistent performance



Durable design:

Tested for thousands of on/off cycles



Customizable:

Motors, voltages, materials, tubing

Technical Specifications

Parameter	Value
Max Flow, Series or Parallel	5.0 or 9.5 L/min (0.18 or 0.34 cfm)
Max Pressure, Series or Parallel	14 or 9 psig (1.0 or 0.6 bar)
Max Vacuum, Series or Parallel	27 or 26 inHg (100 or 133 mbar abs)
Operating Voltage	12 VDC or custom
Max Current Draw	1.1 A
Ambient / Media Temperature	41° F to 104° F (5° C to 40° C)
Weight	3.2 oz (90 g)
Wetted Materials	Glass-Filled LCP, EPDM, Silicone



The **6000 Series** combines **precise flow control** with a **compact, ultra-lightweight design**. Delivering short bursts of pressure and vacuum, these miniature diaphragm pumps ensure **reliable performance even under load**. Tested for thousands of rapid cycles, they offer **long-term durability while maintaining low power consumption**. Fully customizable in motor type, voltages, materials, and tubing configurations, the 6000 Series provides **versatile solutions for applications where accuracy, reliability, and portability are essential**.



6000 SERIES DUAL HEAD MINI DIAPHRAGM PUMP

Compact. Precise. Reliable performance in miniature design.

Flow Curves

Vacuum, DD6114201 (Series)

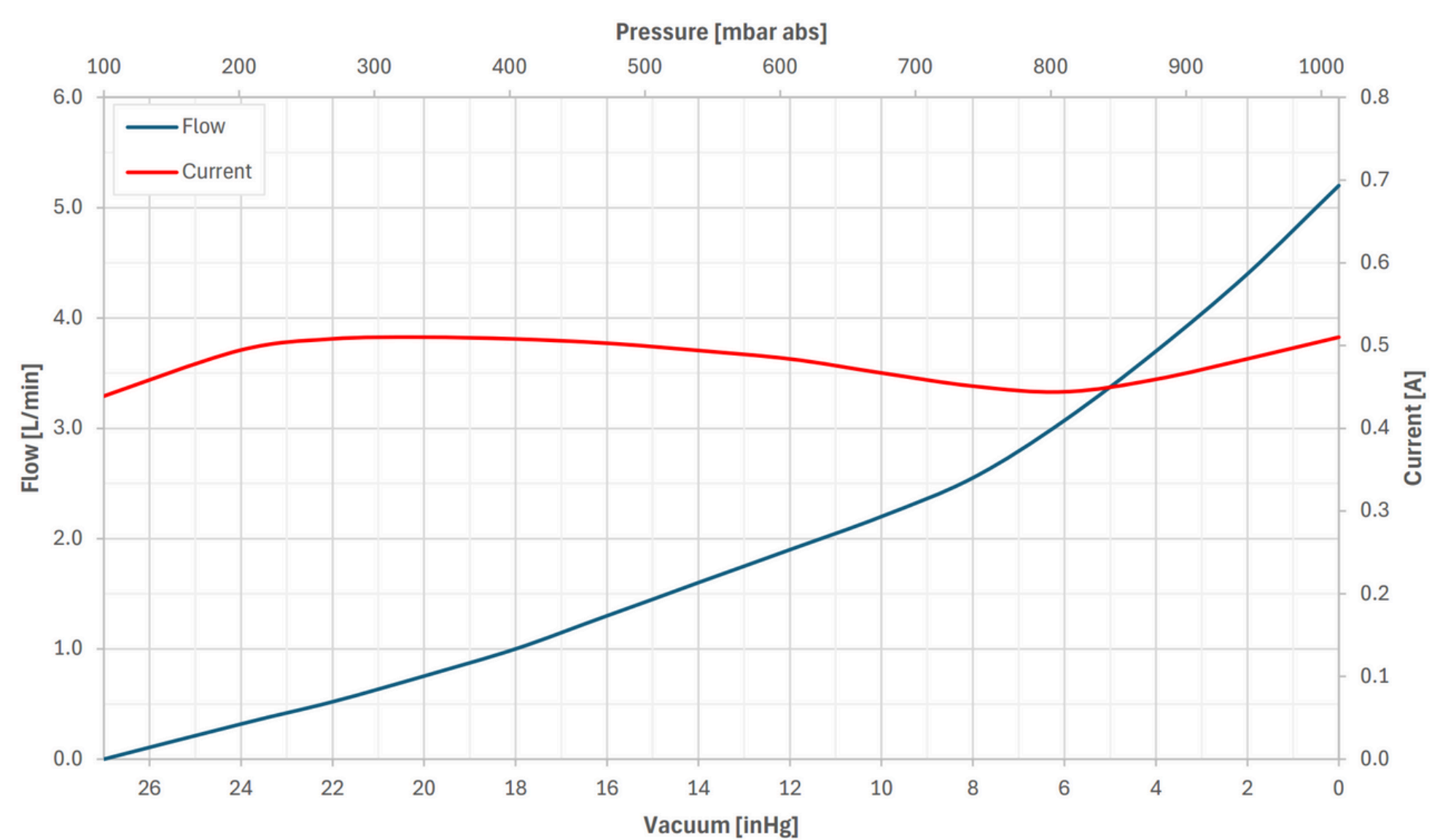

Pressure, DD6114201 (Series)

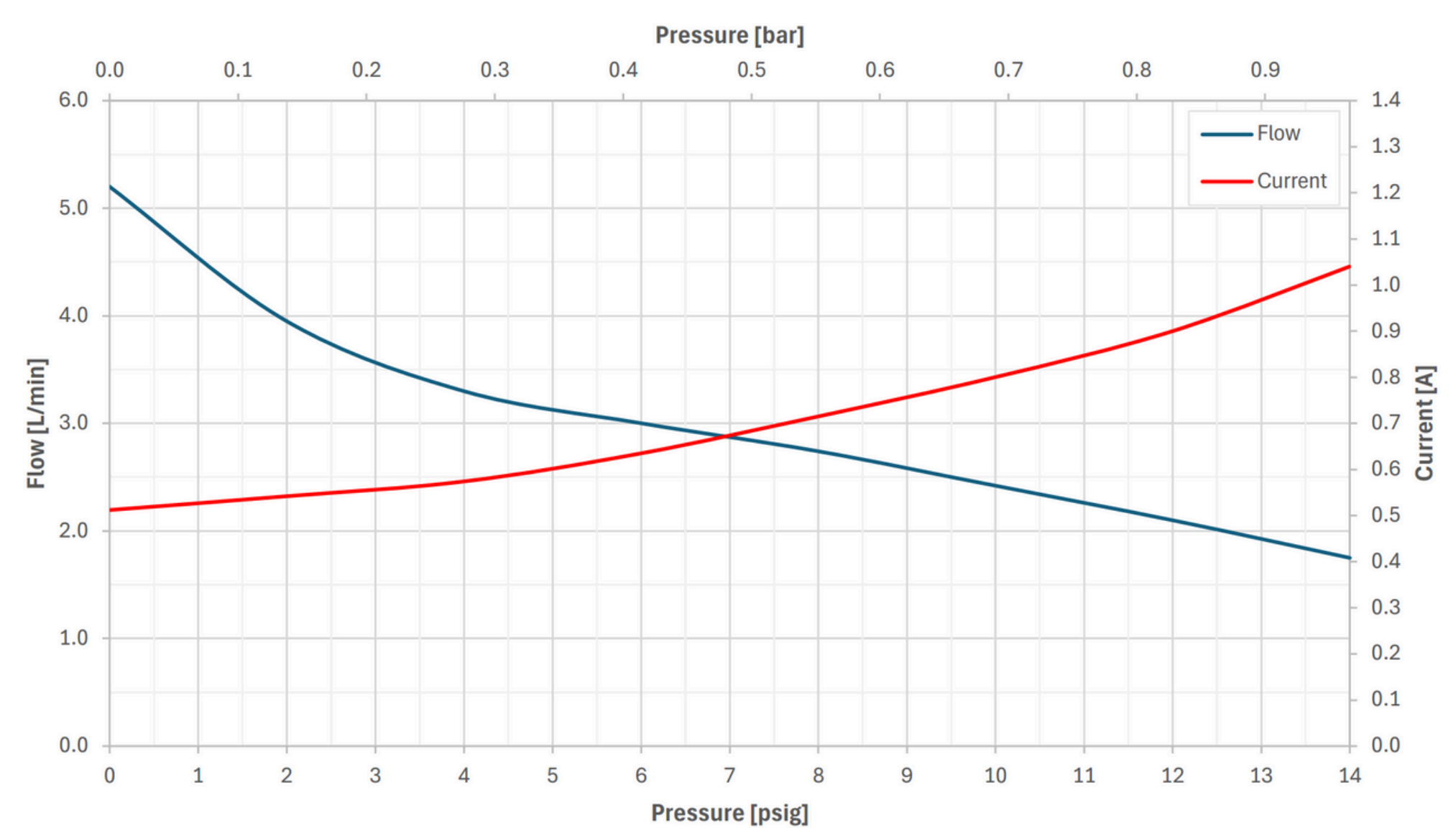

Vacuum, DD6114201 (Parallel)

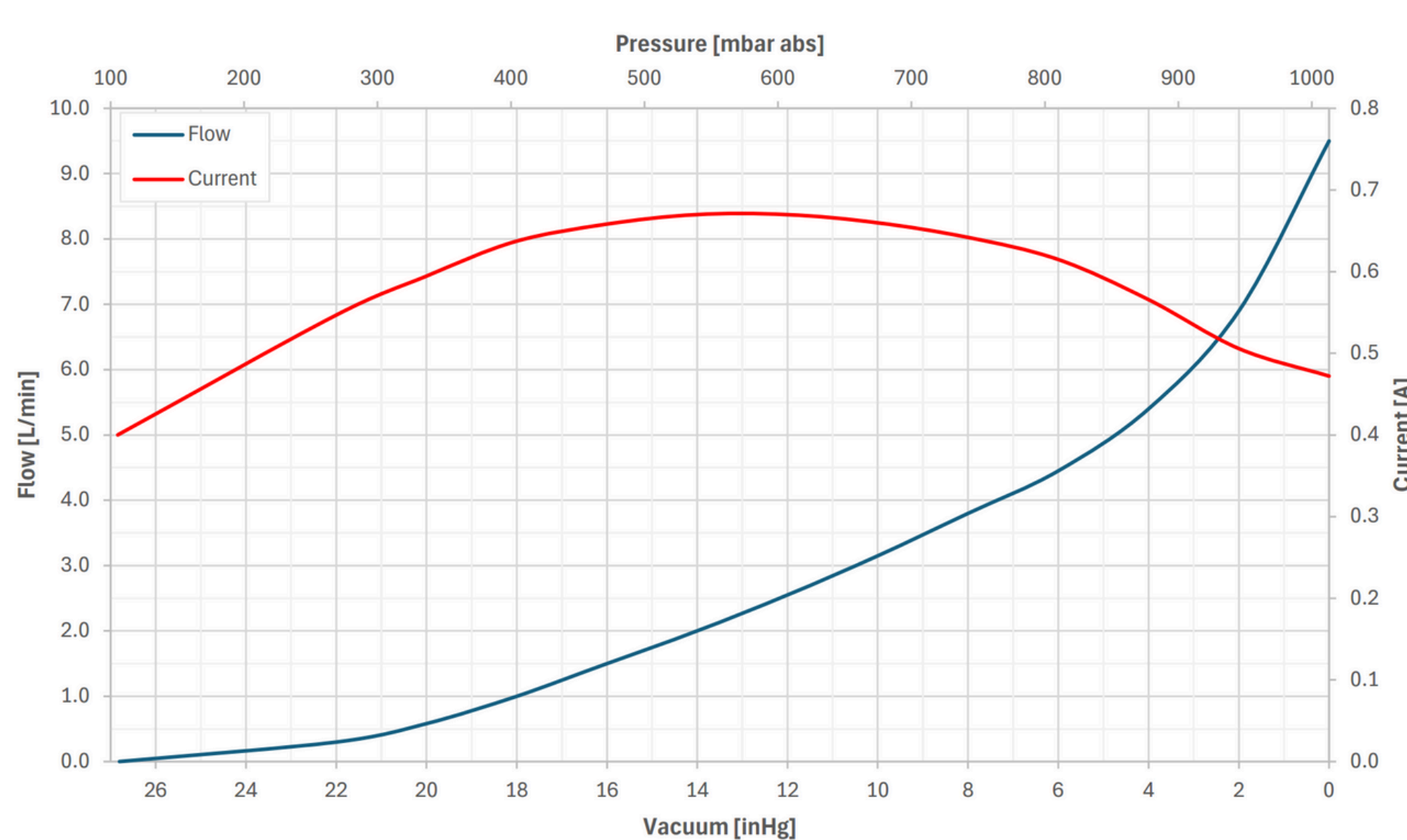

Pressure, DD6114201 (Parallel)

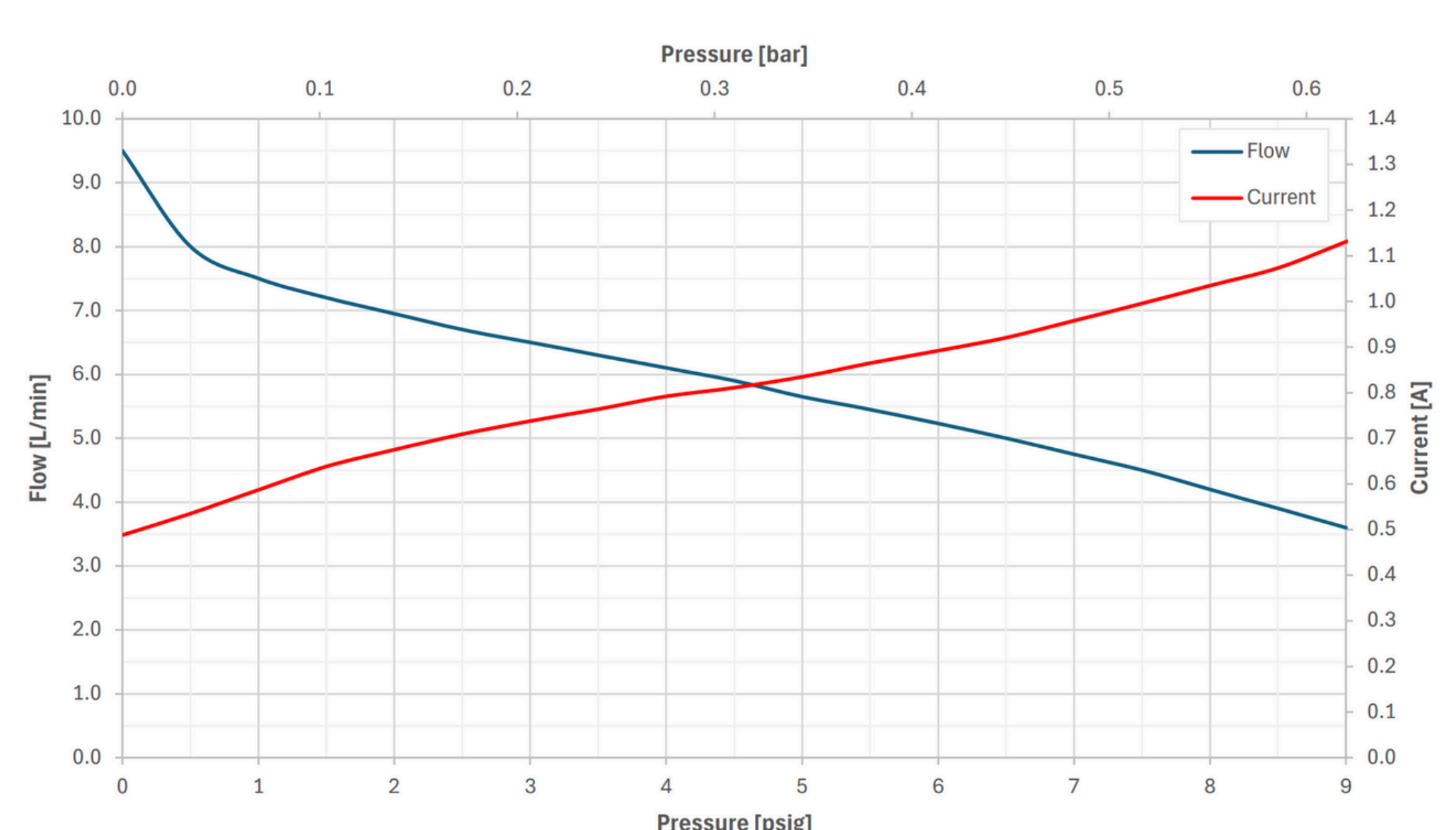

Dimensions

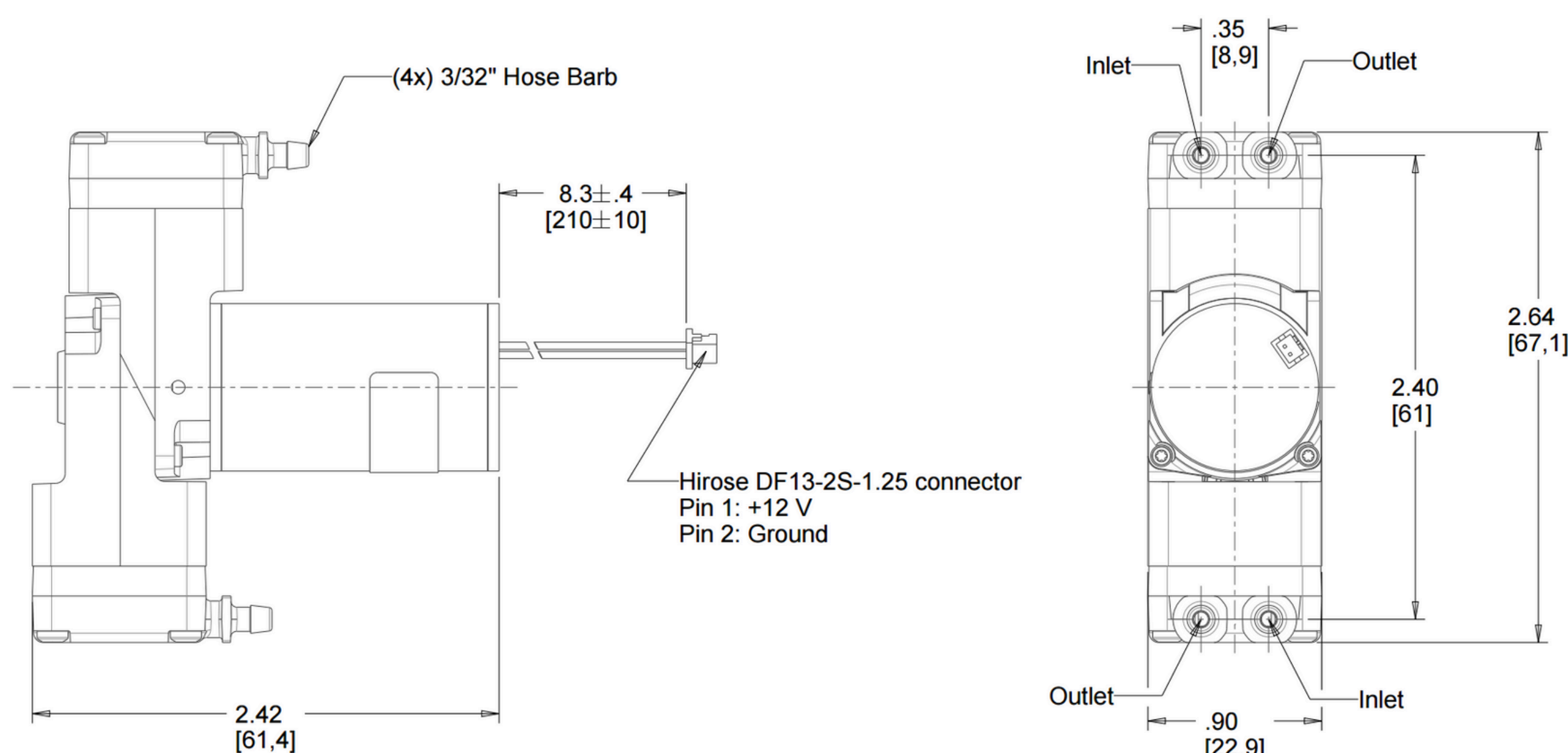

* Dimensions are in inches [mm]. DD6114201 shown. 2.42 [61.4] dimension is motor selection dependent.

Available Customizations

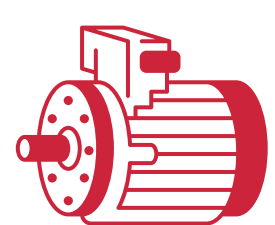

Motor types:
Brushed or Brushless DC



Valve and diaphragm materials

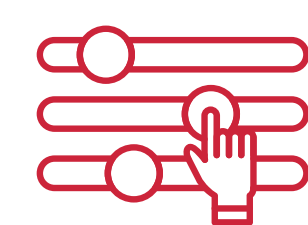

Optional eccentrics
for flow/pressure tuning