



1000 SERIES DUAL HEAD DIAPHRAGM PUMP

Versatile. Durable. Performance-optimized.

Product Snapshot



Max flow: up to **75 L/min** (2.6 cfm)



Max vacuum: **28 inHg** (70 mbar abs)



Max pressure: **40 psig** (2.8 bar)



Motor options: **Brushed or Brushless DC**



Operating voltage: **12 VDC** or **24 VDC**

Key Features



Flexible Integration:

Multiple port styles available



Serviceable design:

Replaceable diaphragms and heads



Proven performance:

Reliable under pressure and vacuum



Efficient design:

Rolled diaphragm boosts airflow



Customizable:

Motor, voltage, materials, and fittings

Technical Specifications

| Parameter | Value |
|----------------------------------|------------------------------------|
| Max Flow, Series or Parallel | 38 or 75 L/min (1.3 or 2.6 cfm) |
| Max Pressure, Series or Parallel | 40 or 18 psig (2.8 or 1.2 bar) |
| Max Vacuum, Series or Parallel | 28 or 24 inHg (70 or 200 mbar abs) |
| Operating Voltage | 12 VDC or 24 VDC |
| Max Current Draw | 4.5 to 6.0 A |
| Ambient / Media Temperature | 41° F to 104° F (5° C to 40° C) |
| Weight | 2.9 lb (1.3 kg) |
| Wetted Materials | PPS, Neoprene, Silicone |



The **1000 Series** combines high flow performance with proven durability in a compact, serviceable design. These small, powerful diaphragm pumps operate efficiently with **low power consumption**, using up to 50% less energy than comparable models. **Fully customizable** and suited for both **pressure and vacuum applications**, they deliver reliable, adaptable performance across use cases from air sampling to medical aspirators and vacuum lifters.



1000 SERIES DUAL HEAD DIAPHRAGM PUMP

Versatile. Durable. Performance-optimized.

Flow Curves

Vacuum, DV1034200 (Series)

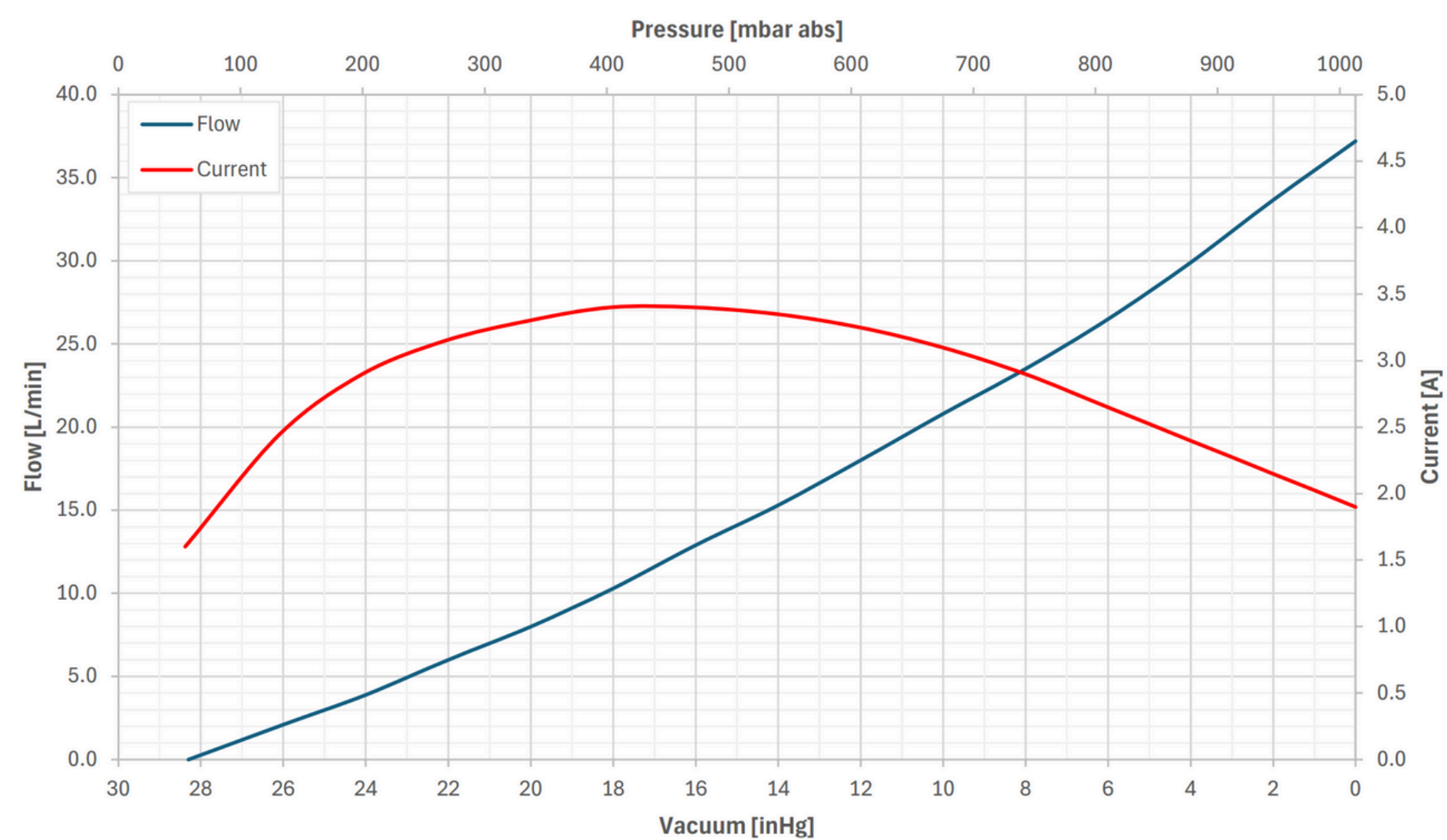

Pressure, DC1034200 (Series)*

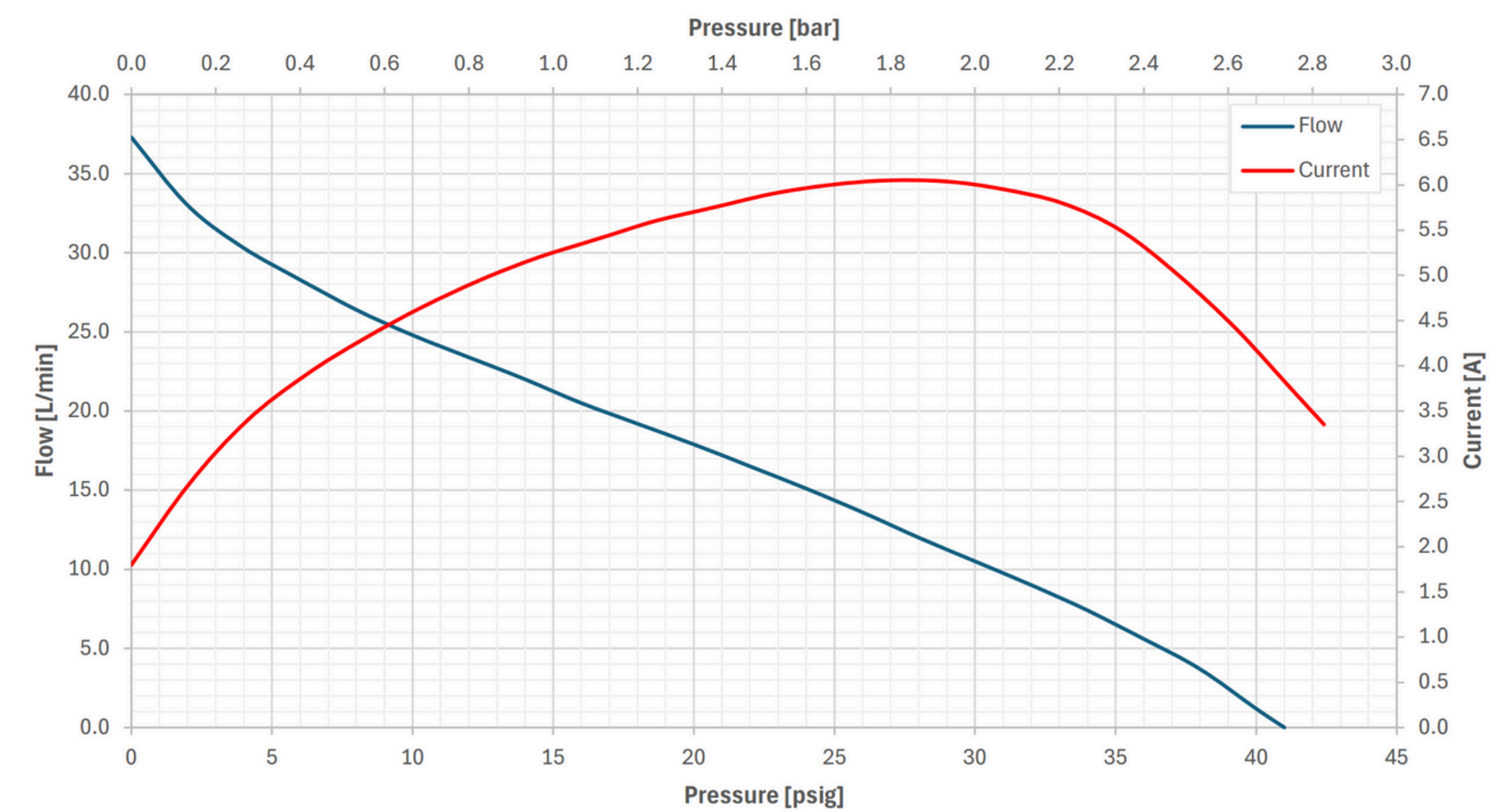

Vacuum, DV1034200 (Parallel)

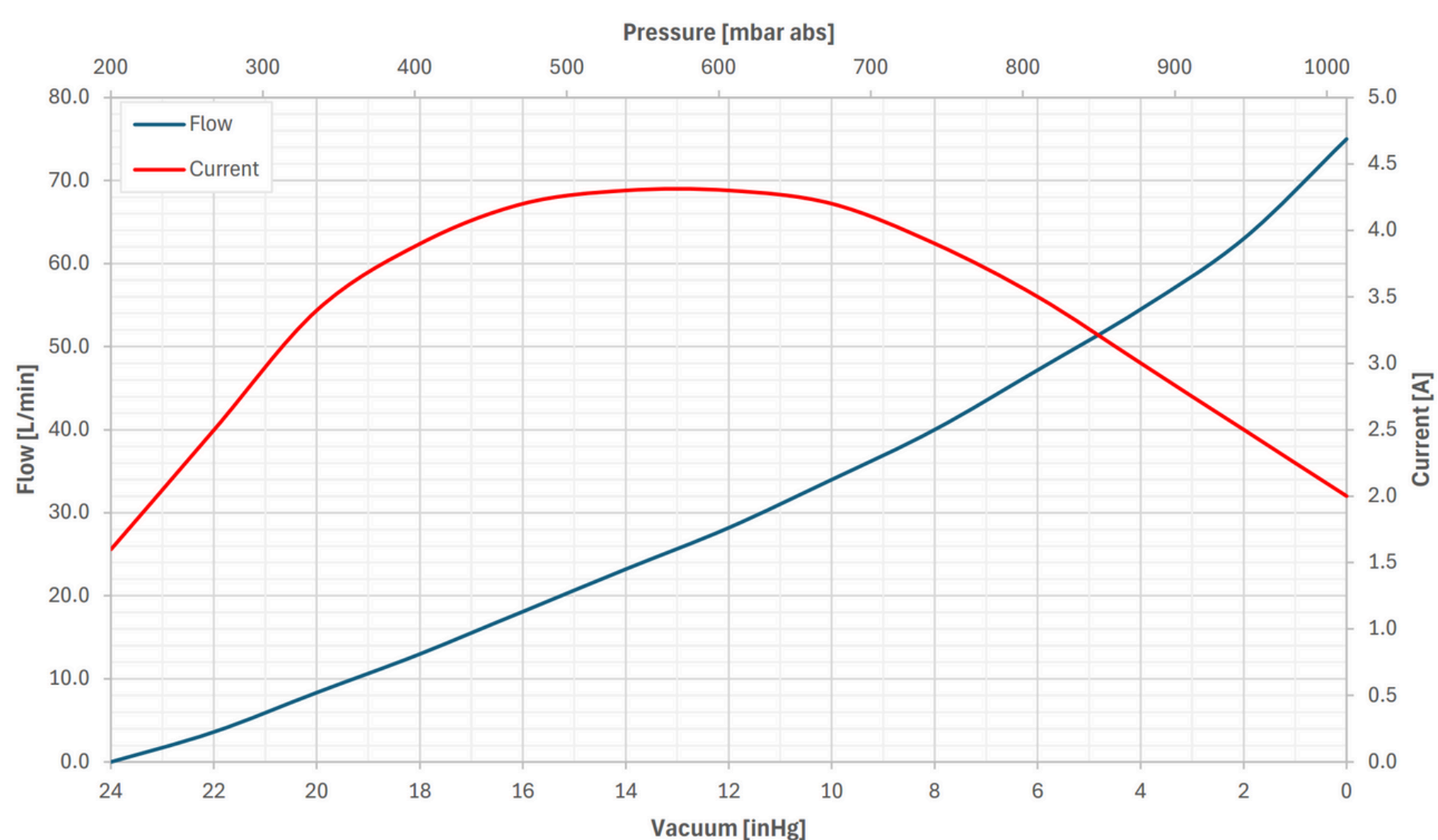

Pressure, DC1034200 (Parallel)*

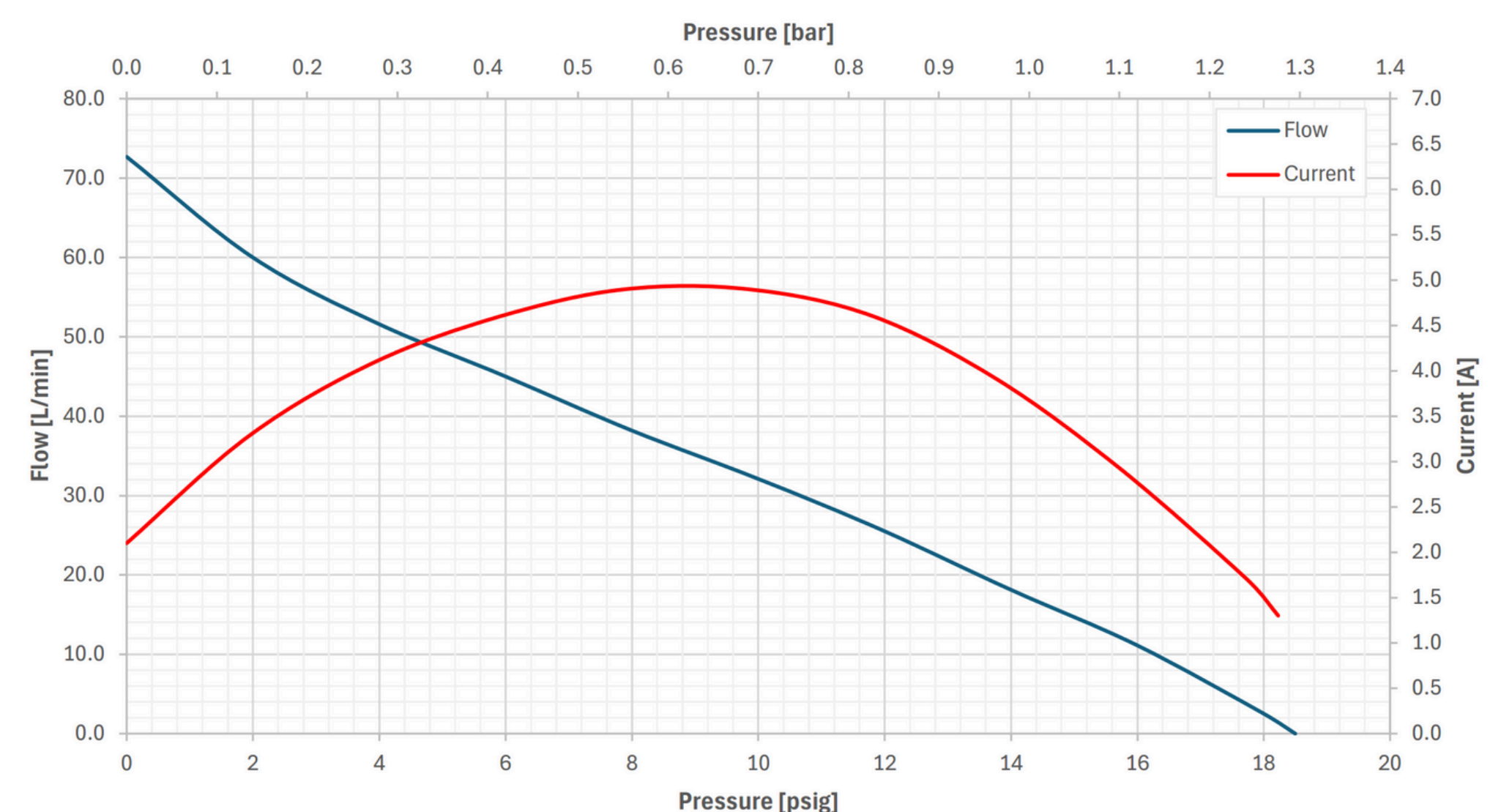

* Diaphragm(s) are inverted 180° from vacuum (DV) configuration to compression (DC) configuration for maximum pressure use.

Dimensions

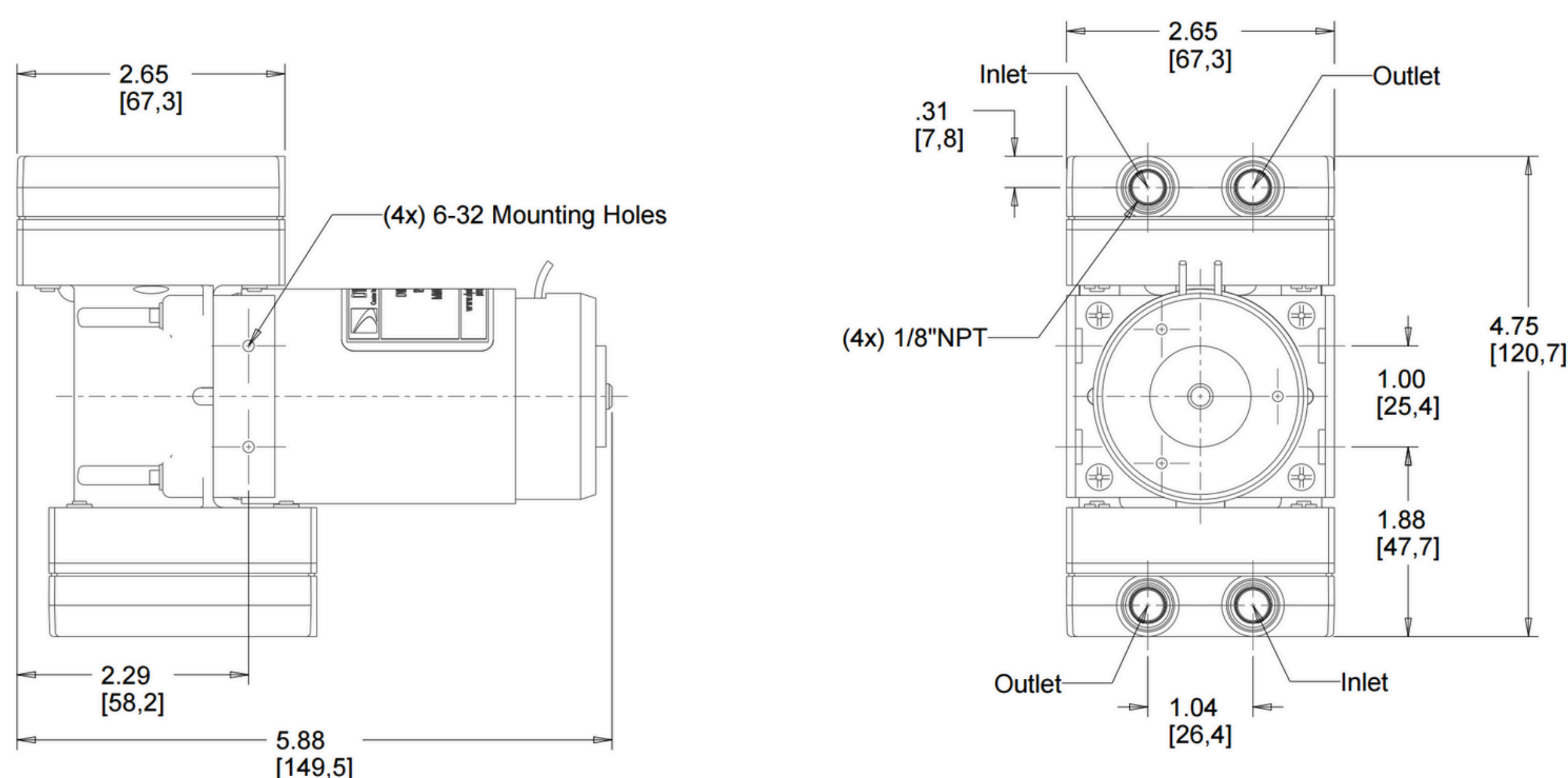

* Dimensions are in inches [mm]. DV1034200 or DC1034200 shown. 5.88 [149,5] dimension is motor selection dependent.

Available Customizations

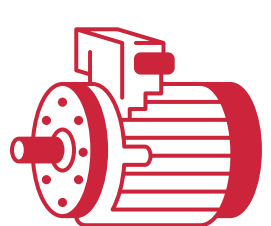

Motor types:
Brushed or Brushless DC

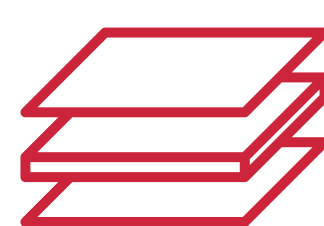

Valve and diaphragm materials

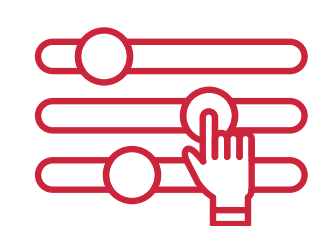

Optional eccentrics
for flow/pressure tuning